

SPECIFICATION
CSR62G2C
PACKAGE OUTLINES

- Notes:
1. All dimensions are in millimeters (inches).
 2. Tolerance is $\pm 0.25\text{mm}$ (0.01") unless otherwise noted.
 3. Specifications are subject to change without notice.

| Part Number | Chip Material | Color of Emission | Lens Type | Viewing Angle |
|-------------|---------------|-------------------|-------------|---------------|
| CSR62G2C | InGaAlP | Green | Water Clear | 130° |

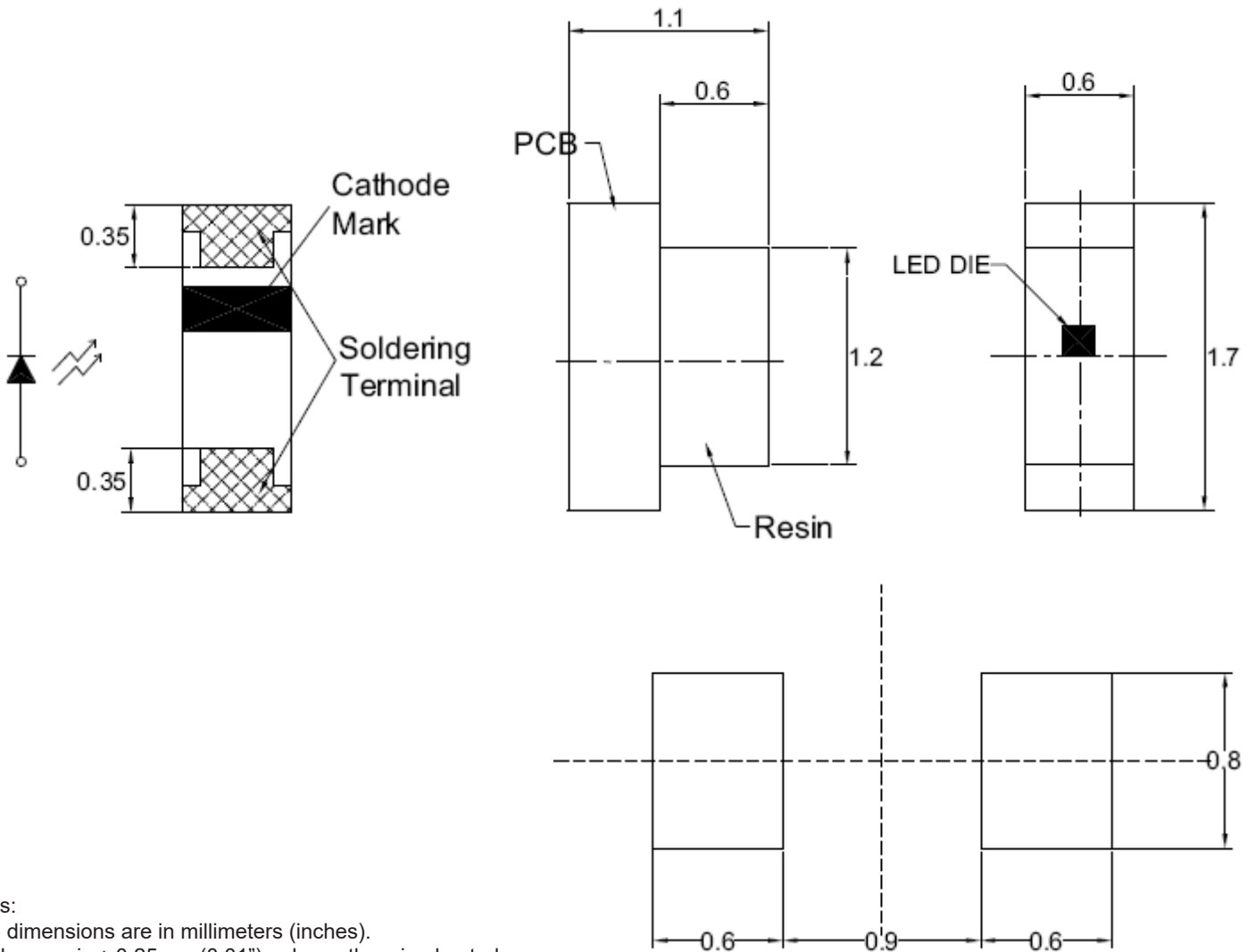

ChromeLED Corp. reserves the right to make changes at any time in order to supply the best product possible. The most current version of this document will always be available at: www.chromeled.com

ABSOLUTE MAXIMUM RATINGS
(TA=25°C)

| Parameter | Symbol | Max Rating | Unit |
|--|--------|-------------------------|------|
| Forward Current | IF | 30 | mA |
| Reverse Current @ 5V | IR | 10 | μA |
| Power Dissipation | Pd | 60 | mW |
| Operating Temperature Range | TOP | -40~+85 | °C |
| Storage Temperature Range | TSTG | -40~+90 | °C |
| Peak Pulsing Current (1/10 duty f = 10KHz) | IFP | 60 | mA |
| Soldering Temperature | TSOL | Max 260°C for 5 sec Max | |

OPTICAL-ELECTRICAL CHARACTERISTICS
(TA=25°C)

| Parameter | Symbol | Test Condition | Value | | | Unit |
|-------------------------|--------|----------------|-------|-----|-----|------|
| | | | Min | Typ | Max | |
| Luminous Intensity | Iv | IF = 20mA | 18 | 40 | - | mcd |
| Forward Voltage | VF | IF = 20mA | - | 2.0 | 2.4 | V |
| Reverse Leakage Current | IR | VR = 5V | - | - | 10 | μA |
| Viewing Angle at 50% Iv | 2θ1/2 | IF = 20mA | - | 130 | - | Deg |
| Peak Wavelength | λP | IF = 20mA | - | 575 | - | nm |
| Dominant Wavelength | λD | IF = 20mA | - | 570 | - | nm |

*Tolerance of viewing angle: -10 / +5 deg.



ChromeLED Corp. reserves the right to make changes at any time in order to supply the best product possible. The most current version of this document will always be available at: www.chromeled.com

OPTICAL CHARACTERISTIC CURVES

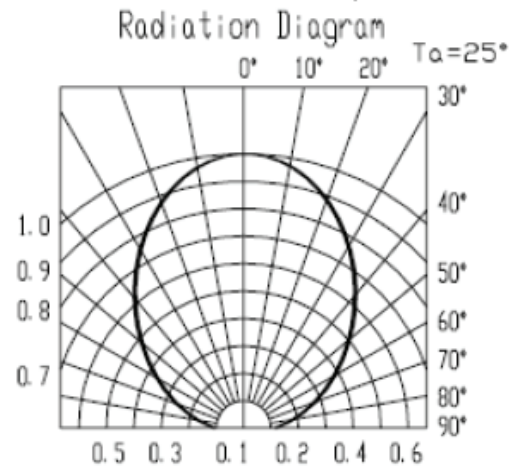
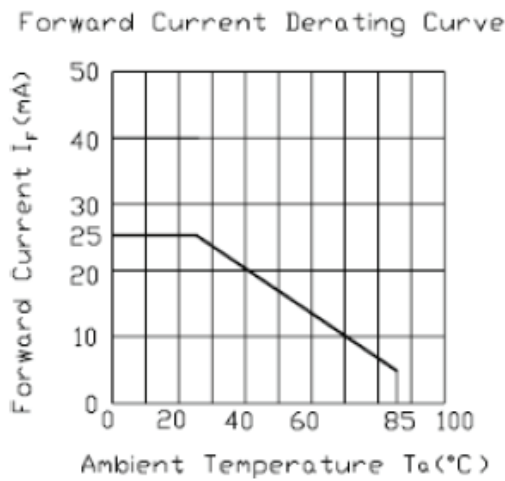
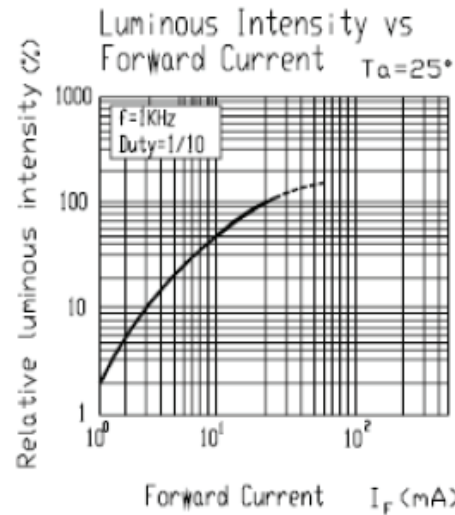
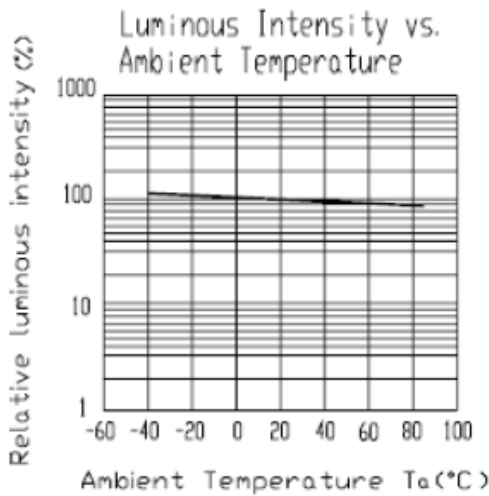
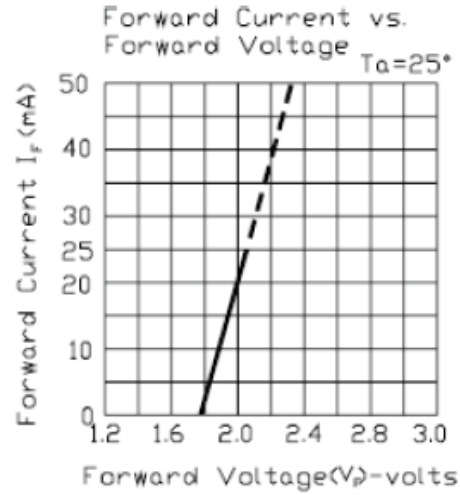
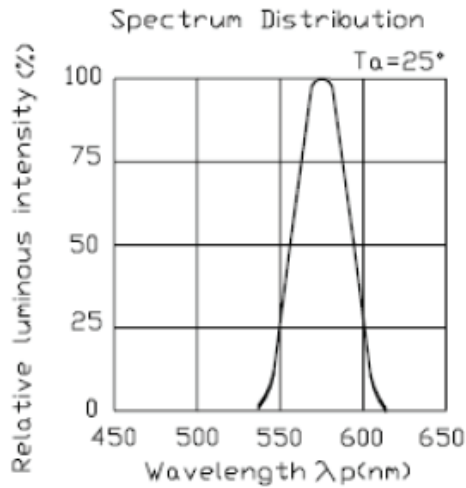

ChromeLED Corp. reserves the right to make changes at any time in order to supply the best product possible. The most current version of this document will always be available at: www.chromeled.com

PACKAGING SPECIFICATION

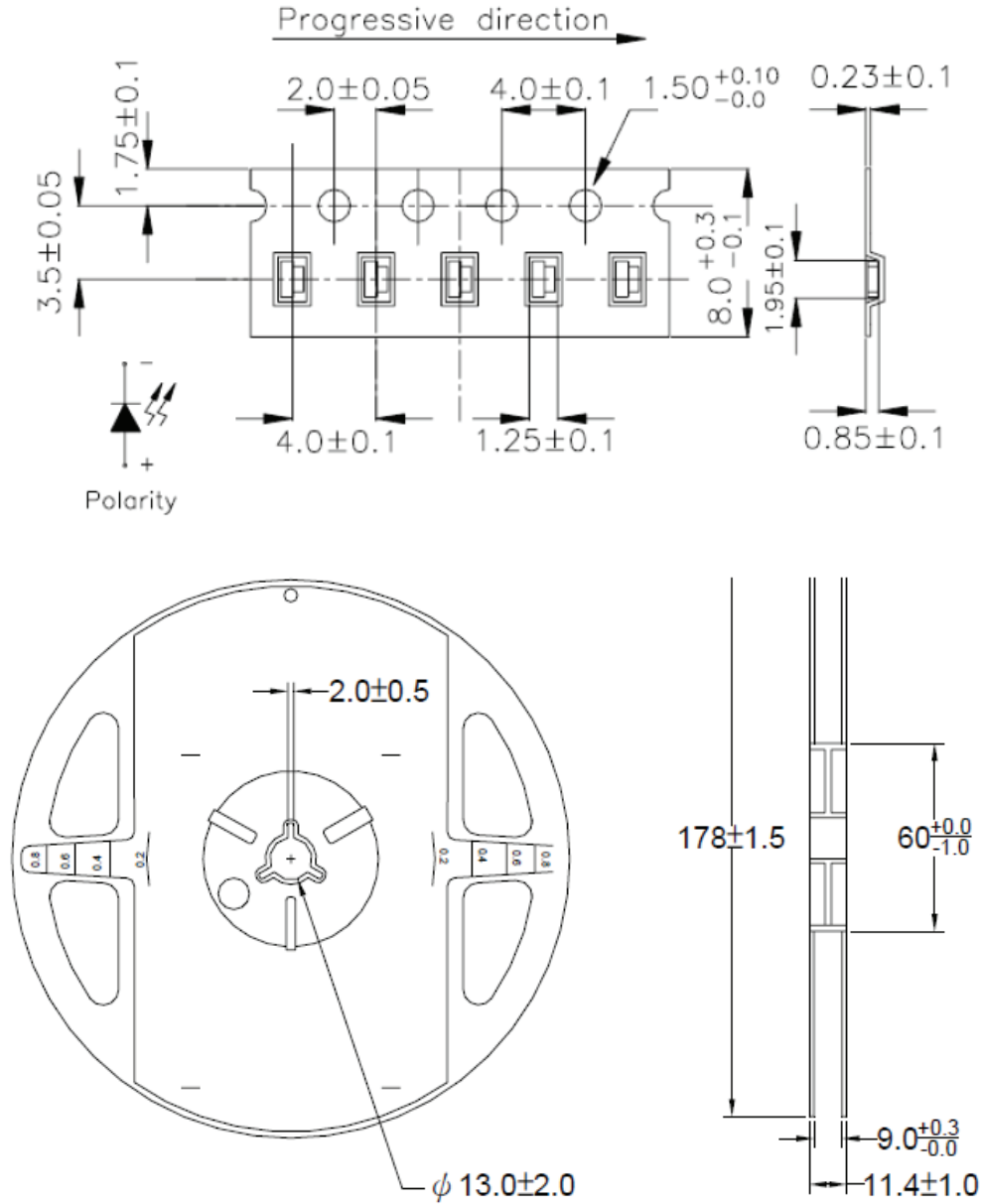

Notes:

1. Tolerance unless mentioned is ±0.1mm, Angle ±0.5, Unit=mm.
2. 3000pcs / 7" Reel; 8.0mm Tape



ChromeLED Corp. reserves the right to make changes at any time in order to supply the best product possible. The most current version of this document will always be available at: www.chromeled.com

SOLDERING CONDITIONS

PRECAUTION FOR USE:

Storage time:

1. Don't open the moisture-resistant bag before LEDs are ready to use.
2. Before use: LEDs should be kept at 30°C or less and 90% RH or less.
3. After use: LEDs floor life is 1 year under 30°C or less and 60% RH or less. If unused LEDs remain, it should be stored in moisture-resistant package.
4. If the LEDs have exceeded the storage time or the moisture absorbent material (silica gel) has faded, the baking treatment of 60±5°C for 24 hrs should be performed.

Over Current-Protection

The LEDs are sensitive parts, slight voltage shift will cause big current change and will cause burn out. Customer must apply resistors for protection.

LED SOLDERING

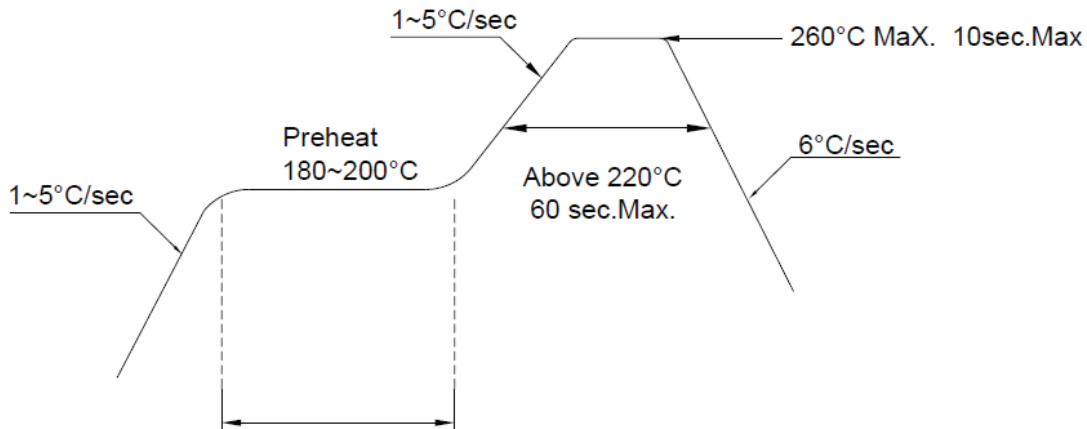

Notes:

1. Reflow soldering should not be done more than two times.
2. When soldering, do not put stress on the LEDs during heating.
3. After soldering, do not warp circuit board.

REPAIRING

In principle repair should not be done after the LEDs have been soldered. When repairing is unavoidable, it should be confirmed beforehand not to be damaged whether the characteristics of the LEDs by repairing and a double-head soldering iron should be used.



ChromeLED Corp. reserves the right to make changes at any time in order to supply the best product possible. The most current version of this document will always be available at: www.chromeled.com