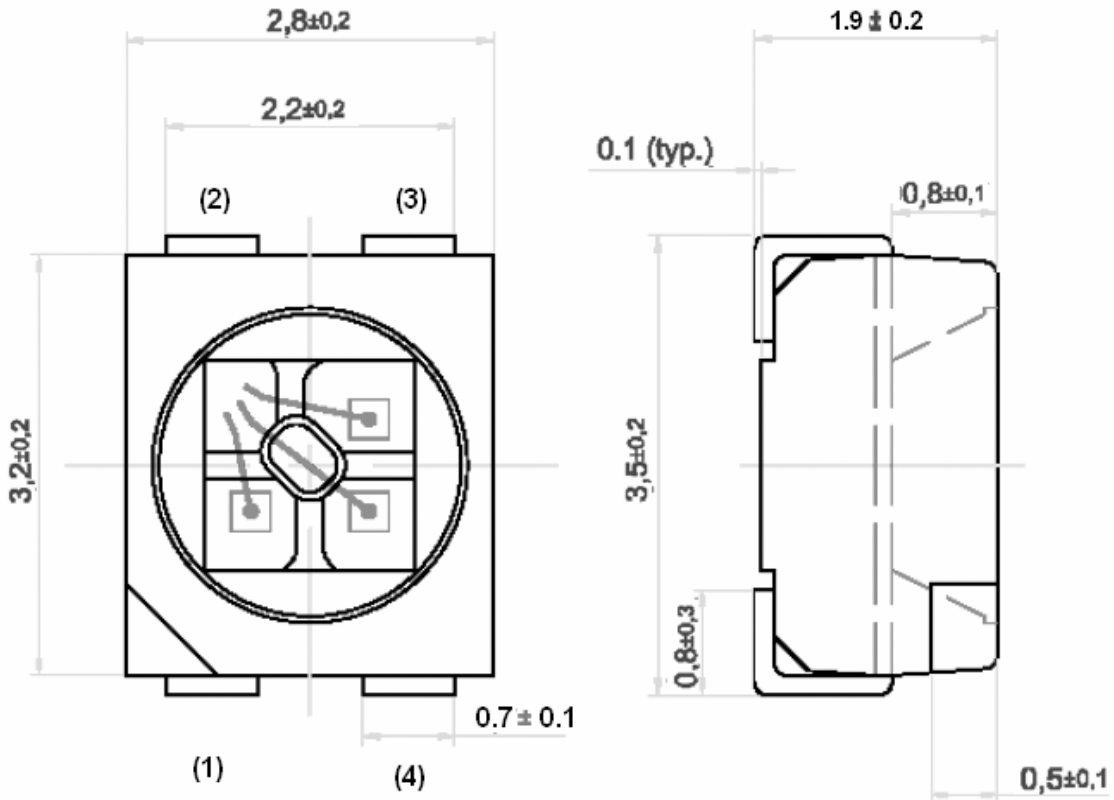

**SPECIFICATION** **CSPT1311R2GT2B2**
**PACKAGE OUTLINES**

(1) Cathode Red (2) Common Anode (3) Blue (4) Green

**Notes:**

1. All dimensions are in millimeters (inches).
2. Tolerance is  $\pm 0.25$ mm (0.01") unless otherwise noted.
3. Specifications are subject to change without notice.

Part Number	Chip Material	Color of Emission	Lens Type	Viewing Angle
CSPT1311R2GT2B2C	InGaAlP	Red	Water Clear	120°
	InGaN	Green	Water Clear	120°
	InGaN	Blue	Water Clear	120°



ChromeLED Corp. reserves the right to make changes at any time in order to supply the best product possible. The most current version of this document will always be available at: [www.chromeled.com](http://www.chromeled.com)

**ABSOLUTE MAXIMUM RATINGS**
**(TA=25°C)**

Parameter	Symbol	Max Rating		Unit
		Red	Blue/Green	
Forward Current	I <sub>F</sub>	30	20	mA
Reverse Voltage	V <sub>R</sub>	12	5	V
Power Dissipation	P <sub>d</sub>	75	85	mW
Operating Temperature Range	T <sub>OP</sub>	-40~+100		°C
Storage Temperature Range	T <sub>STG</sub>	-40~+100		°C
Peak Pulsing Current (t <sub>p</sub> ≤ 10 μ S, duty cycle = 0.005)	I <sub>FP</sub>	1000	200	mA
Soldering Temperature	T <sub>SOL</sub>	Max 260°C for 5 sec Max		

**OPTICAL-ELECTRICAL CHARACTERISTICS**
**(TA=25°C)**

Parameter	Symbol	Test Condition	Color	Value			Unit
				Min	Typ	Max	
Luminous Intensity	I <sub>v</sub>	I <sub>F</sub> = 20mA	Red	140	200	-	mcd
			Green	200	285		
			Blue	50	100		
Forward Voltage	V <sub>F</sub>	I <sub>F</sub> = 20mA	Red	-	1.8	2.45	V
			Green	-	3.6	4.25	
			Blue	-	3.6	4.25	
Viewing Angle at 50% I <sub>v</sub>	2θ <sub>1/2</sub>	I <sub>F</sub> = 20mA	-	-	120	-	Deg
Dominant Wavelength	λ <sub>D</sub>	I <sub>F</sub> = 20mA	Red	-	620	-	nm
			Green		525		
			Blue		470		

\*Tolerance of viewing angle: -10 / +5 deg.

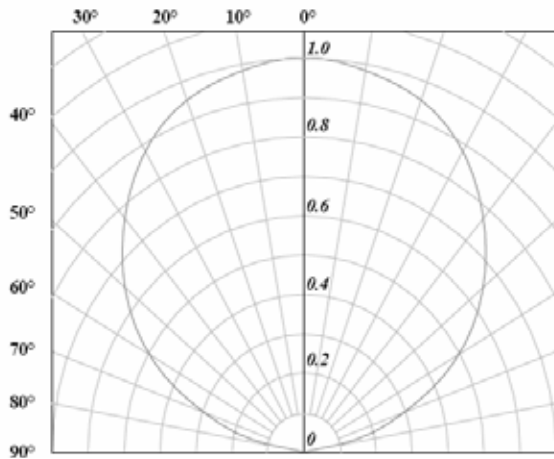
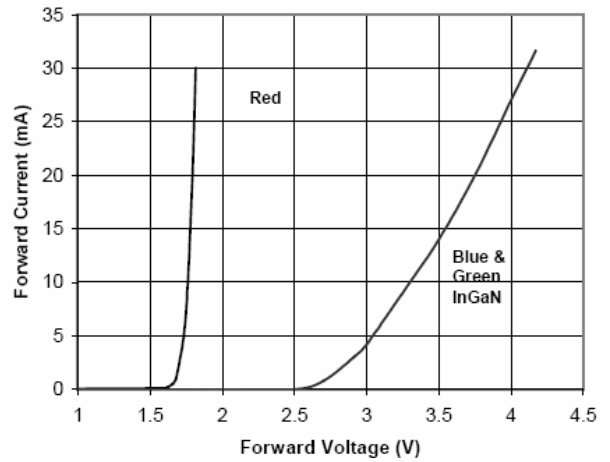
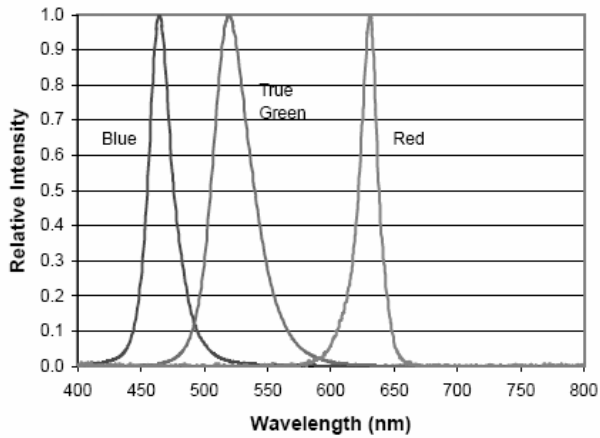
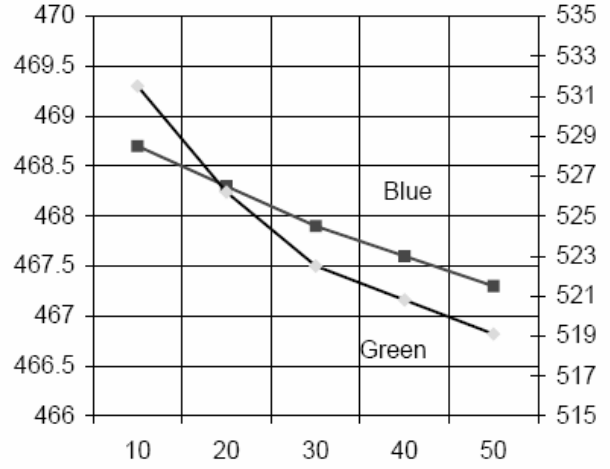
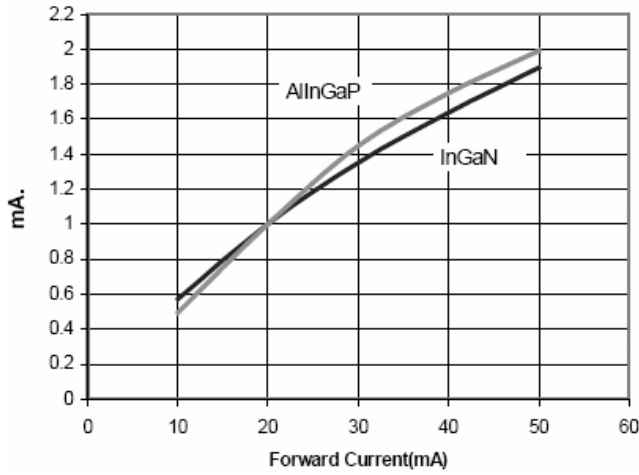

 ChromeLED Corp. reserves the right to make changes at any time in order to supply the best product possible. The most current version of this document will always be available at: [www.chromeled.com](http://www.chromeled.com)

## TYPICAL ELECTRO-OPTICAL CHARACTERISTIC CURVES

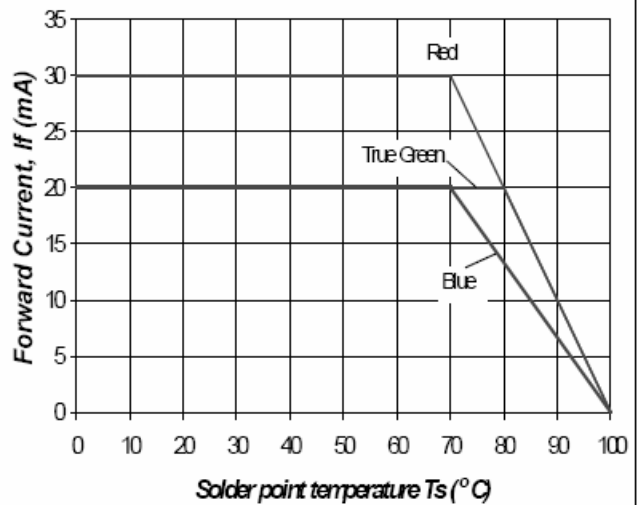
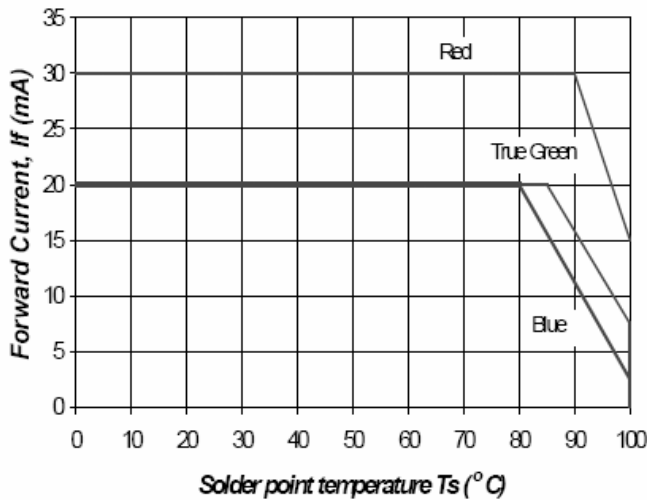
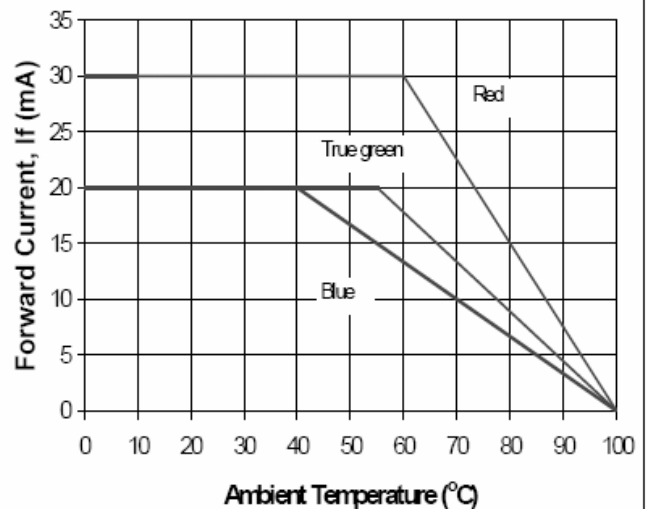
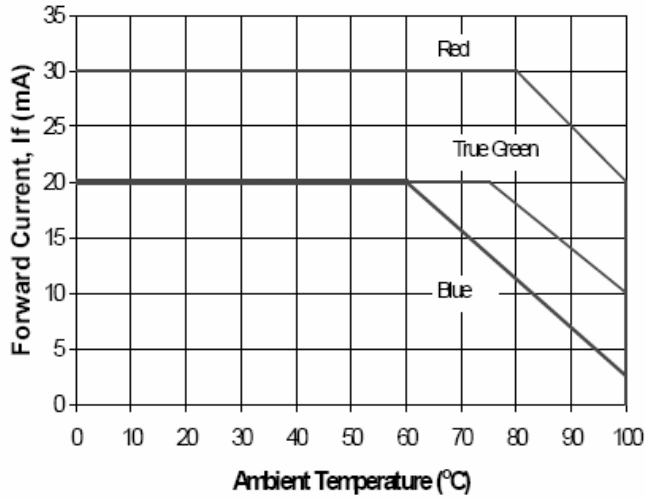

ChromeLED Corp. reserves the right to make changes at any time in order to supply the best product possible. The most current version of this document will always be available at: [www.chromeled.com](http://www.chromeled.com)

## TYPICAL ELECTRO-OPTICAL CHARACTERISTIC CURVES



ChromeLED Corp. reserves the right to make changes at any time in order to supply the best product possible. The most current version of this document will always be available at: [www.chromeled.com](http://www.chromeled.com)

# RECOMMENDED SOLDER PAD

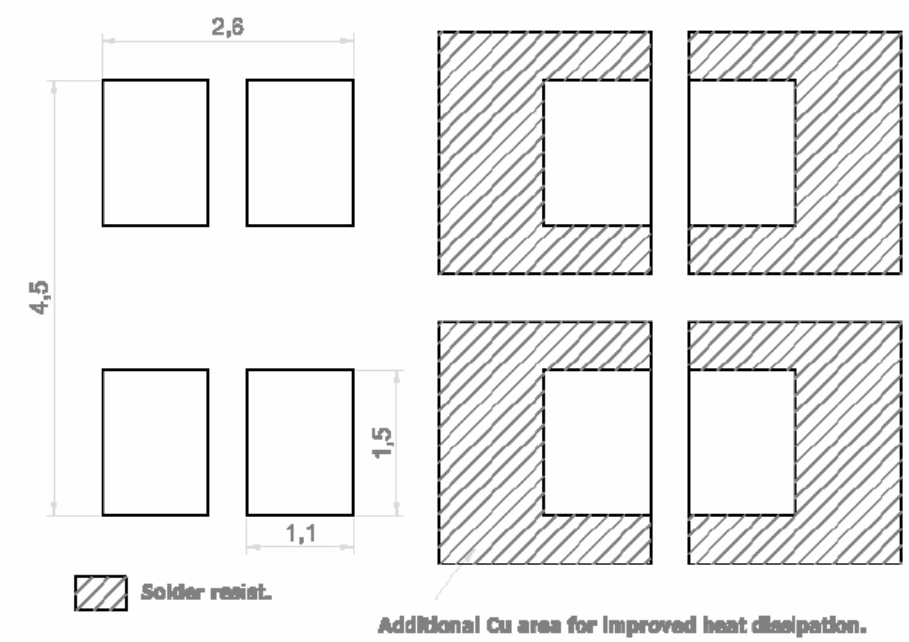

ChromeLED Corp. reserves the right to make changes at any time in order to supply the best product possible. The most current version of this document will always be available at: [www.chromeled.com](http://www.chromeled.com)

**SOLDERING CONDITIONS**

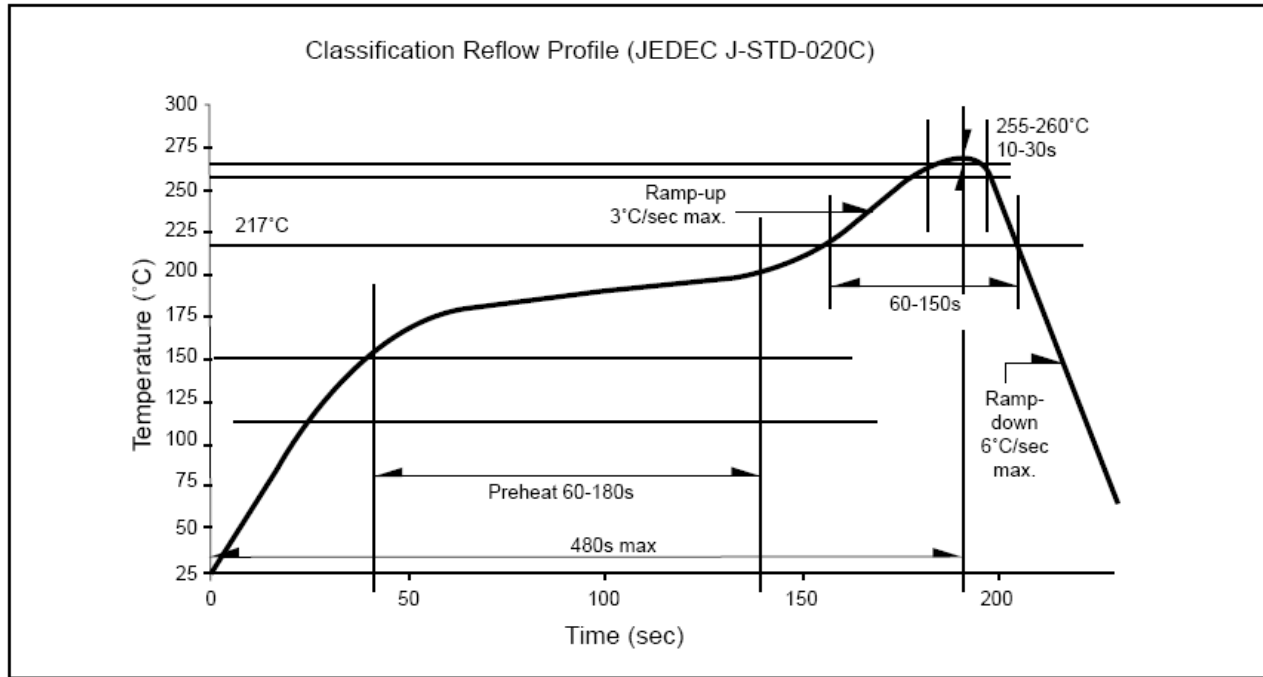
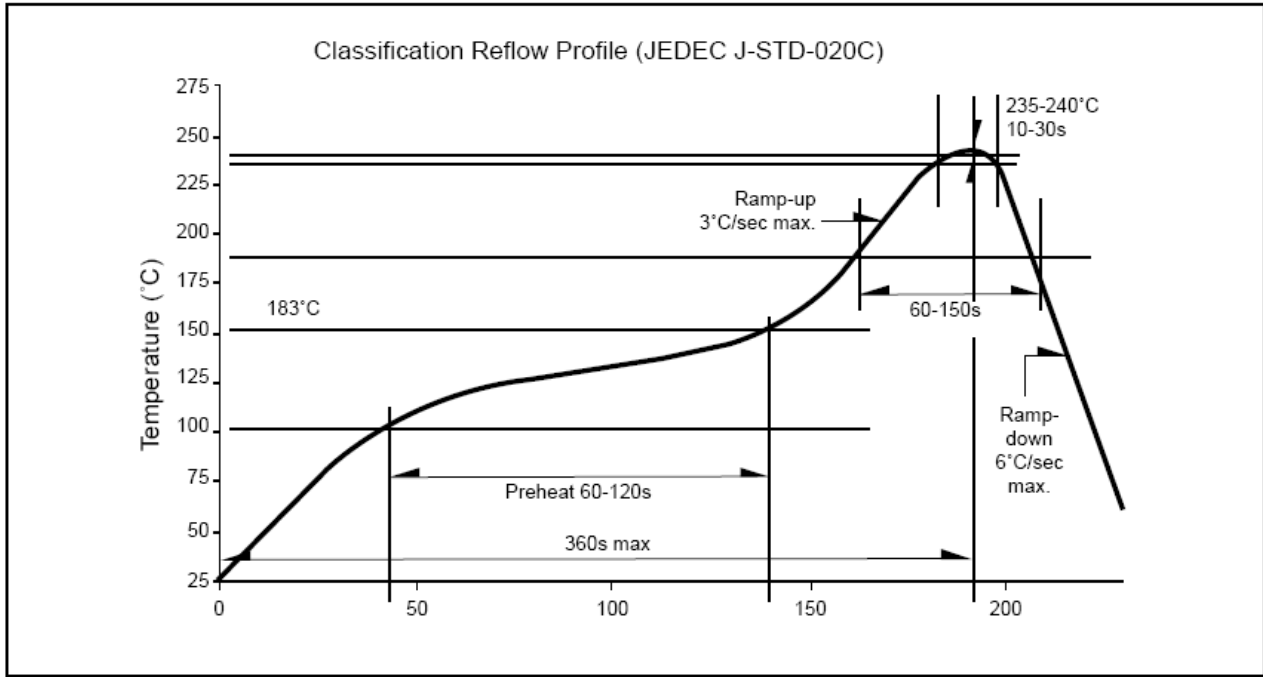

ChromeLED Corp. reserves the right to make changes at any time in order to supply the best product possible. The most current version of this document will always be available at: [www.chromeled.com](http://www.chromeled.com)

## REEL PACKAGING

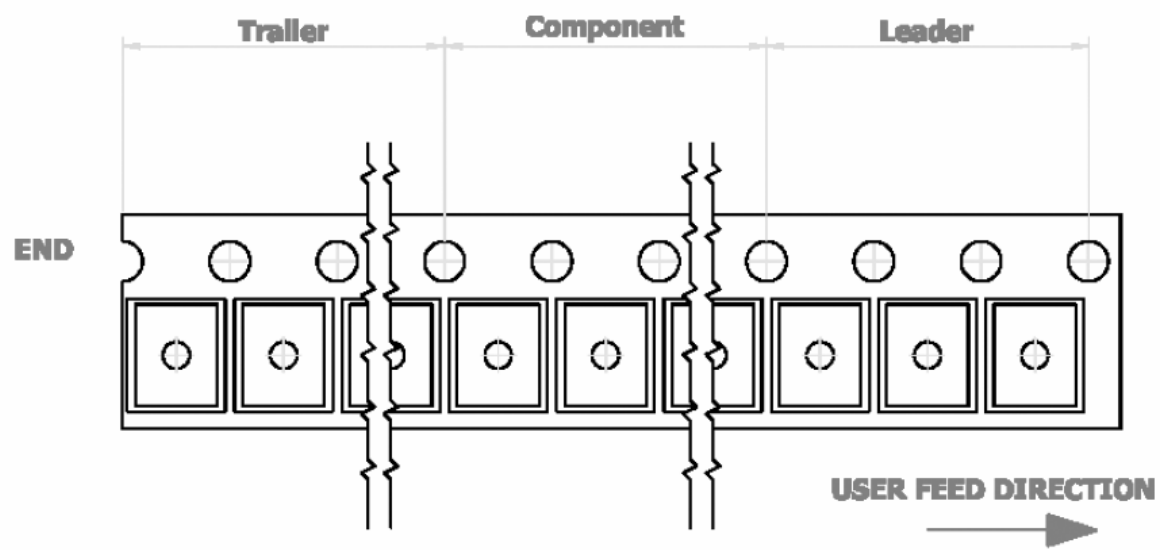
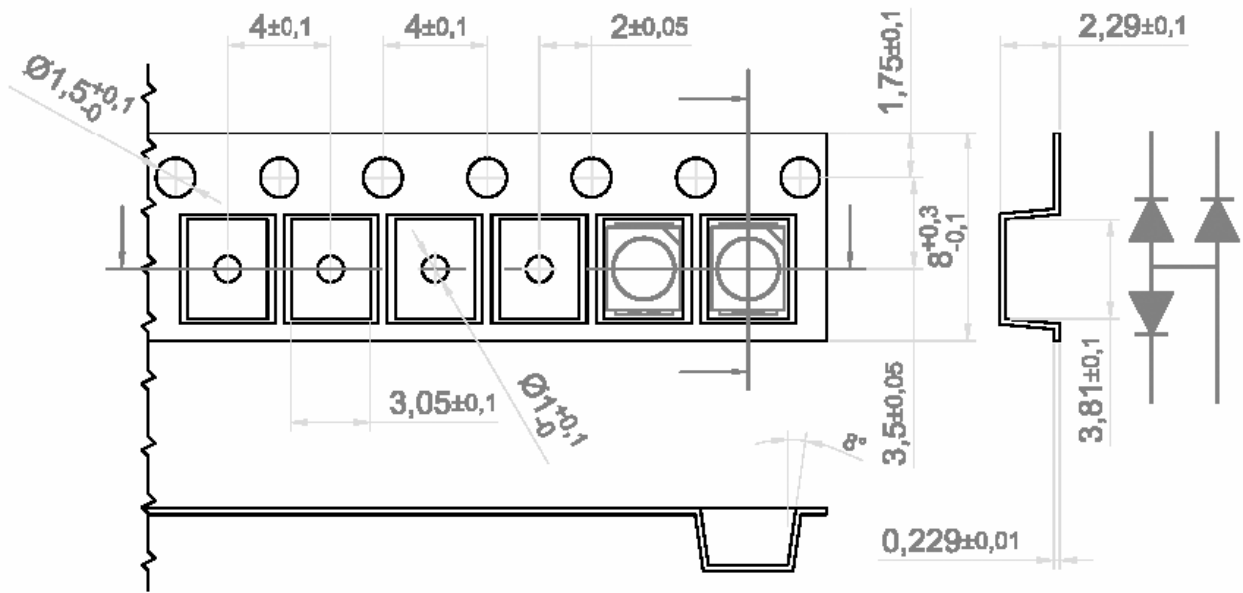

ChromeLED Corp. reserves the right to make changes at any time in order to supply the best product possible. The most current version of this document will always be available at: [www.chromeled.com](http://www.chromeled.com)