

**SPECIFICATION** **CSP88R4GT3B3C**
**PACKAGE OUTLINES**

**Notes:**

1. All dimensions are in millimeters (inches).
2. Tolerance is  $\pm 0.25\text{mm}$  (0.01") unless otherwise noted.
3. Specifications are subject to change without notice.

Part Number	Chip Material	Color of Emission	Lens Type	Viewing Angle
CSP88R4GT3B3C	InGaAlP	Red	Water Clear	120°
	InGaN	Green	Water Clear	120°
	InGaN	Blue	Water Clear	120°

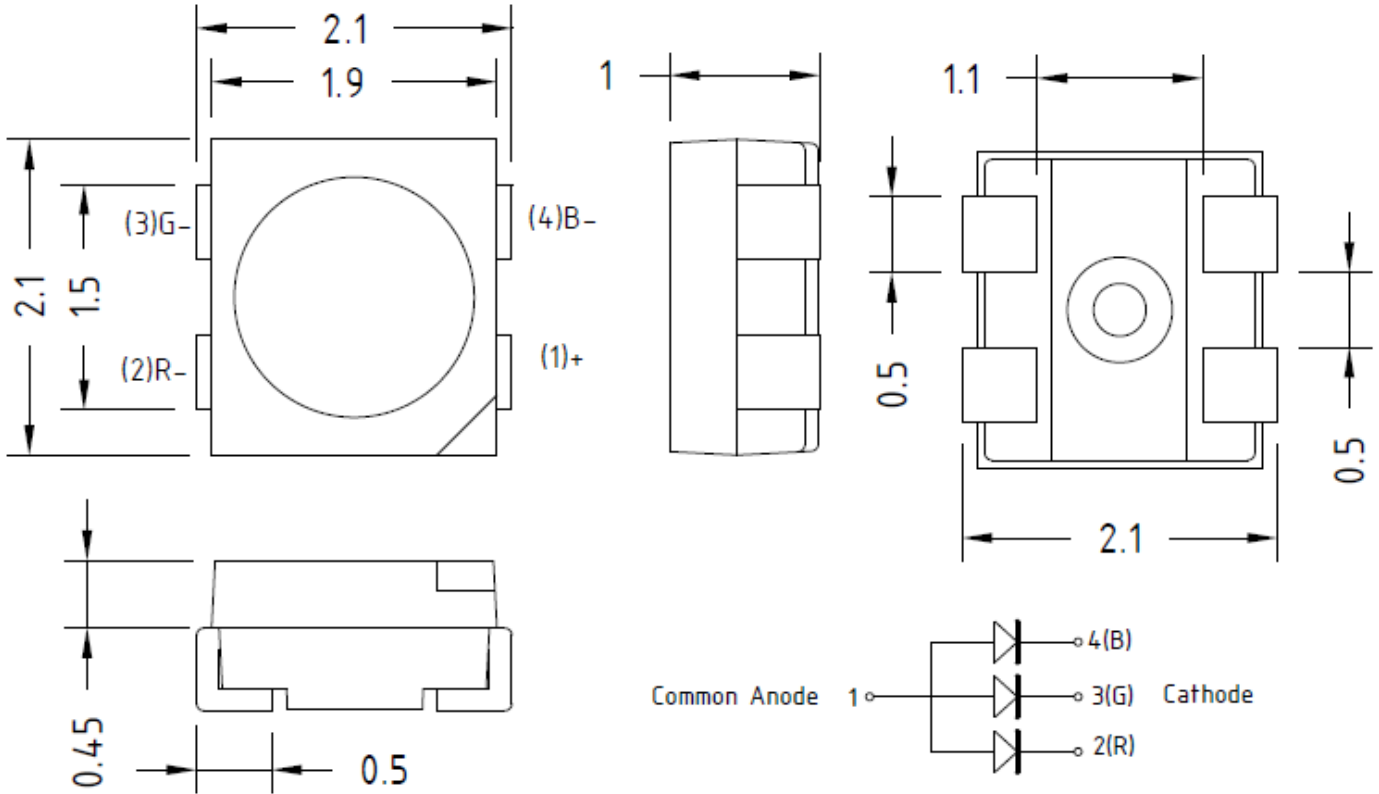

ChromeLED Corp. reserves the right to make changes at any time in order to supply the best product possible. The most current version of this document will always be available at: [www.chromeled.com](http://www.chromeled.com)

**ABSOLUTE MAXIMUM RATINGS**
**(TA=25°C)**

Parameter	Symbol	Max Rating		Unit
		Red	Green/Blue	
Forward Current	I <sub>F</sub>	30	25	mA
Reverse Voltage	V <sub>R</sub>	5	5	V
Power Dissipation	P <sub>d</sub>	72	90	mW
Operating Temperature Range	T <sub>OP</sub>	-30~+85		°C
Storage Temperature Range	T <sub>STG</sub>	-40~+100		°C
Peak Pulsing Current	I <sub>FP</sub>	100	100	mA
Soldering Temperature	T <sub>SOL</sub>	Max 260°C for 5 sec Max		

**OPTICAL-ELECTRICAL CHARACTERISTICS**
**(TA=25°C)**

Parameter	Symbol	Test Condition	Color	Value			Unit
				Min	Typ	Max	
Luminous Intensity	I <sub>v</sub>	I <sub>F</sub> = 20mA	Red	210	330	-	mcd
			Green	400	560		
			Blue	100	130		
Forward Voltage	V <sub>F</sub>	I <sub>F</sub> = 20mA	Red	-	2.0	2.4	V
			Green	-	3.2	3.6	
			Blue	-	3.2	3.6	
Viewing Angle at 50% I <sub>v</sub>	2θ <sub>1/2</sub>	I <sub>F</sub> = 20mA	-	-	120	-	Deg
Dominant Wavelength	λ <sub>D</sub>	I <sub>F</sub> = 20mA	Red	-	625	-	nm
			Green		525		
			Blue		470		

\*Tolerance of viewing angle: -10 / +5 deg.



 ChromeLED Corp. reserves the right to make changes at any time in order to supply the best product possible. The most current version of this document will always be available at: [www.chromeled.com](http://www.chromeled.com)

## TYPICAL ELECTRO-OPTICAL CHARACTERISTIC CURVES

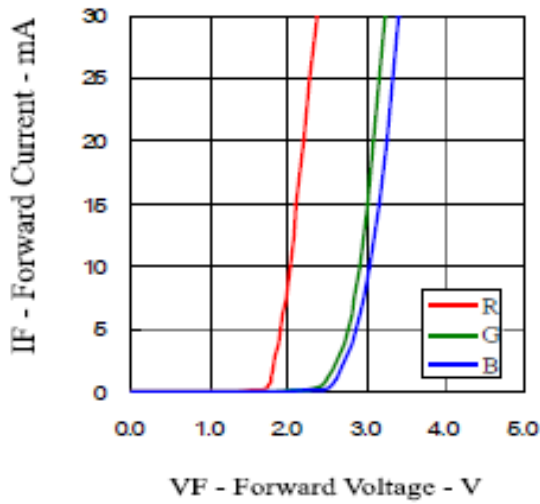
Forward Current vs. Forward Voltage

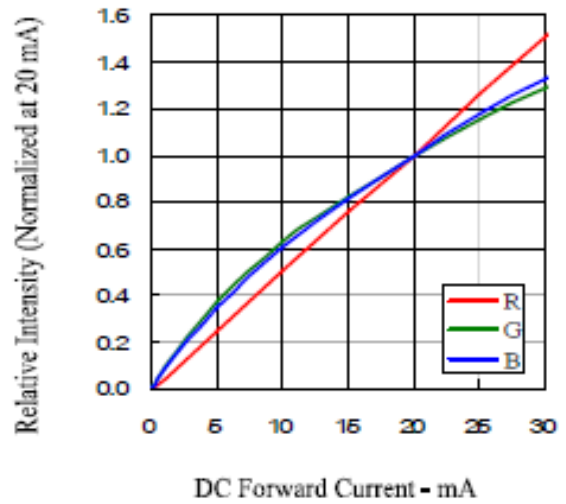

Relative Intensity vs. Forward Current



Forward Current vs. Ambient Temperature

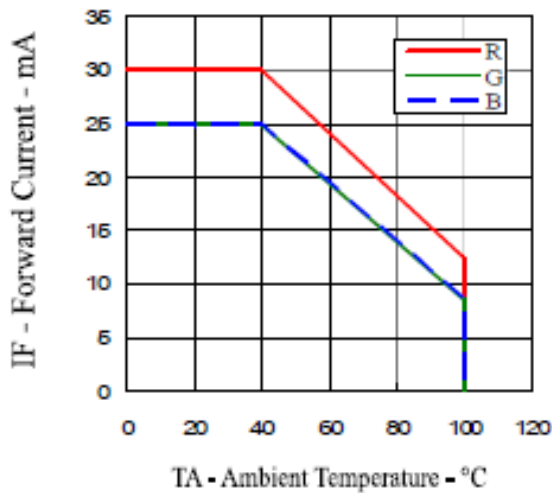

Relative Intensity vs. Wavelength

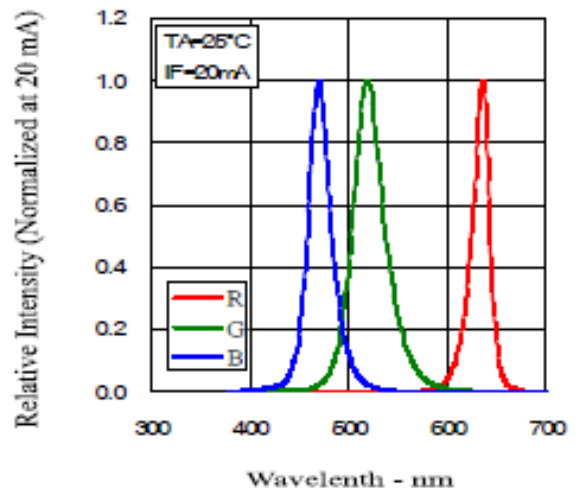

ChromeLED Corp. reserves the right to make changes at any time in order to supply the best product possible. The most current version of this document will always be available at: [www.chromeled.com](http://www.chromeled.com)

## RADIATION PATTERN

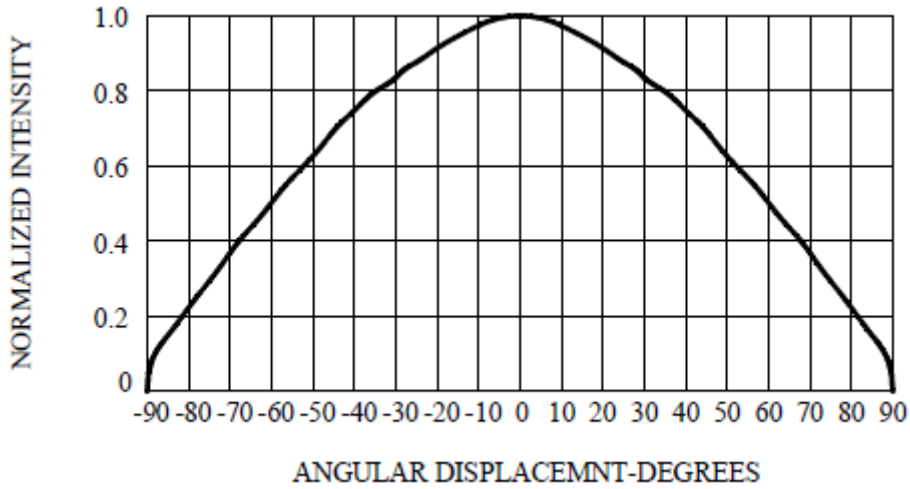

## RECOMMENDED SOLDERING PAD PATTERN

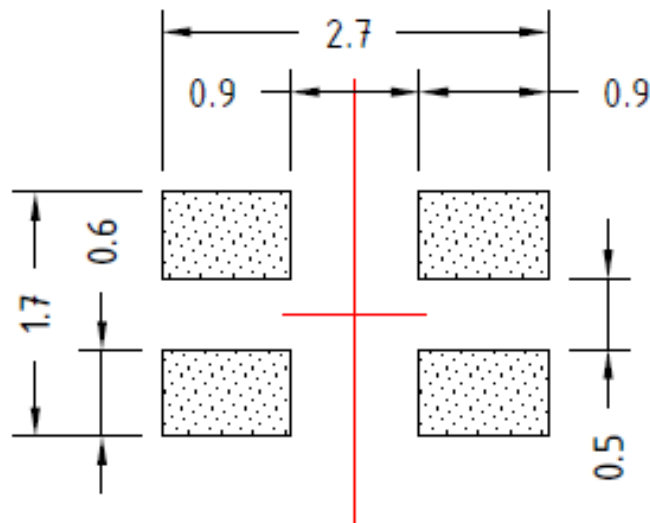

ChromeLED Corp. reserves the right to make changes at any time in order to supply the best product possible. The most current version of this document will always be available at: [www.chromeled.com](http://www.chromeled.com)

# SOLDERING CONDITIONS

## RECOMMENDED Sn-PB IR-Reflow Soldering Profile



## RECOMMENDED Pb-Free Soldering Profile



ChromeLED Corp. reserves the right to make changes at any time in order to supply the best product possible. The most current version of this document will always be available at: [www.chromeled.com](http://www.chromeled.com)

## REEL PACKAGING

- Feeding Direction

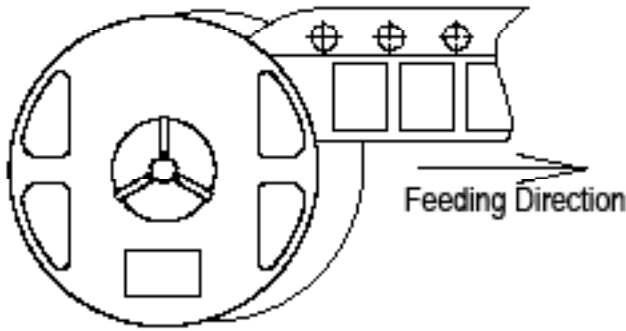

- Dimensions of Reel (Unit: mm)

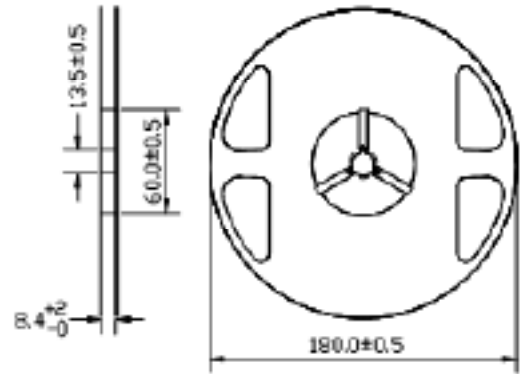

- Dimensions of Tape (Unit: mm)

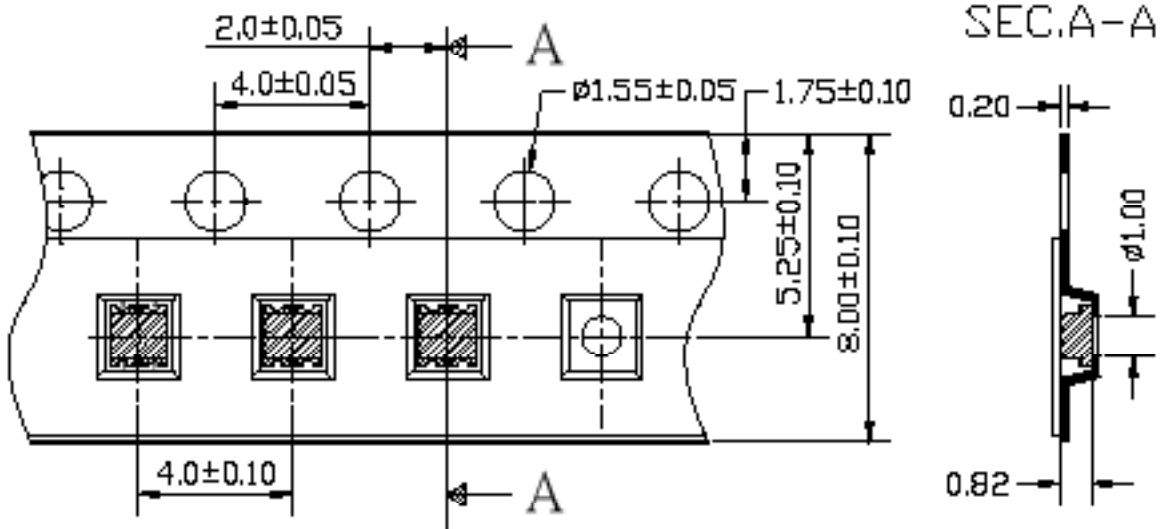

ChromeLED Corp. reserves the right to make changes at any time in order to supply the best product possible. The most current version of this document will always be available at: [www.chromeled.com](http://www.chromeled.com)