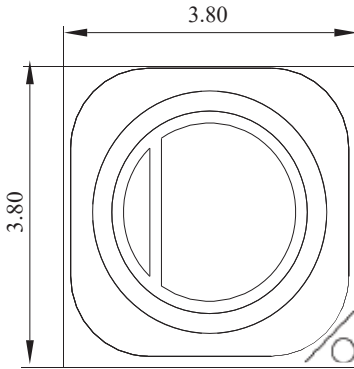
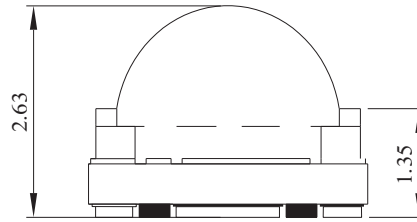
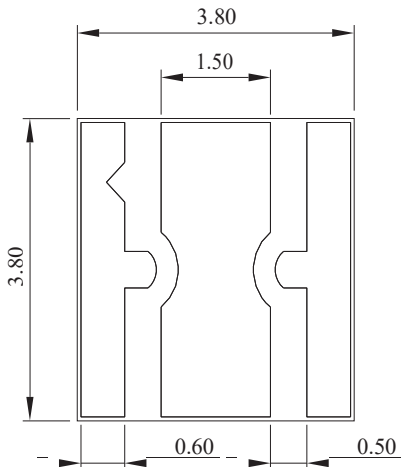
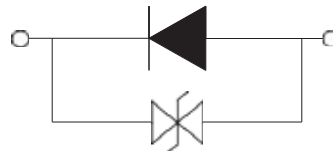
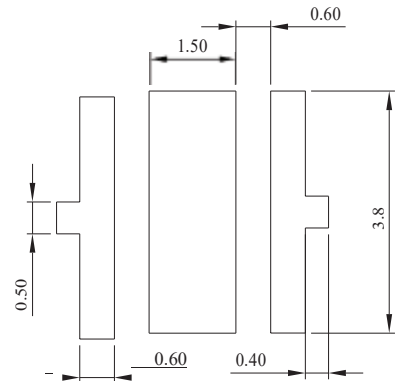

SPECIFICATION
CSHDF1515UV365QC
PACKAGE OUTLINES

Fig.1-1 Top view 正面视图

Fig.1-2 Side view 侧面视图

Fig.1-3 Bottom view 背面视图

Polarity
Fig.1-4 Polarity 极性

Fig.1-5 Soldering patterns 推荐焊盘
Notes:

1. All dimensions are in millimeters (inches).
2. Tolerance is $\pm 0.25\text{mm}$ (0.01") unless otherwise noted.
3. Specifications are subject to change without notice.

Part Number	Chip Material	Color of Emission	Lens Type	Viewing Angle
CSHDF1515UV365QC	InGaN	Ultraviolet	Water Clear	120°



ChromeLED Corp. reserves the right to make changes at any time in order to supply the best product possible. The most current version of this document will always be available at: www.chromeled.com

ABSOLUTE MAXIMUM RATINGS
(TA=25°C)

Parameter	Symbol	Max Rating	Unit
Forward Current	IF	1200	mA
Reverse Current @ 5V	IR	5	μA
Power Dissipation	Pd	3-4	W
Operating Temperature Range	TOP	-40~+85	°C
Storage Temperature Range	TSTG	-40~+100	°C
Soldering Temperature	TSOL	Max 260°C for 5 sec Max	

OPTICAL-ELECTRICAL CHARACTERISTICS
(TA=25°C)

Parameter	Symbol	Test Condition	Value			Unit
			Min	Typ	Max	
Radiant Flux	ΦE	IF = 1000mA	1545	-	1825	mW
Forward Voltage	VF	IF = 1000mA	3.4	3.6	3.8	V
Thermal Resistance	RTHJ-S	IF = 1000mA	-	4.5	-	C/W
Peak Wavelength	nm	IF = 1000mA	-	365	-	nm

*Tolerance of viewing angle: -10 / +5 deg.



ChromeLED Corp. reserves the right to make changes at any time in order to supply the best product possible. The most current version of this document will always be available at: www.chromeled.com

OPTICAL CHARACTERISTIC CURVES

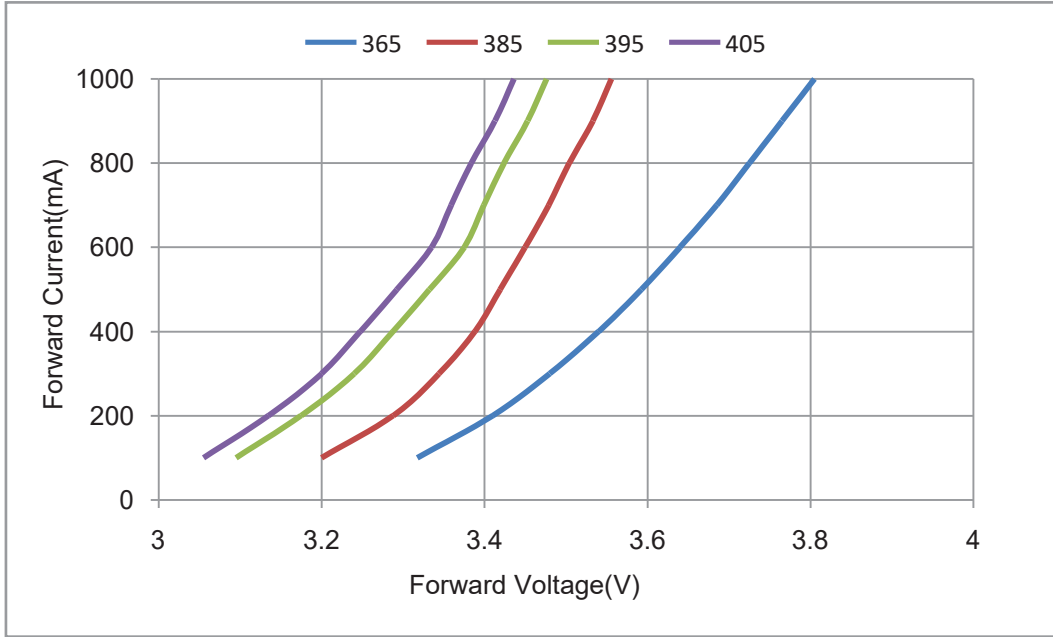

Fig.1- Forward Voltage Vs. Forward Current 伏安特性曲线

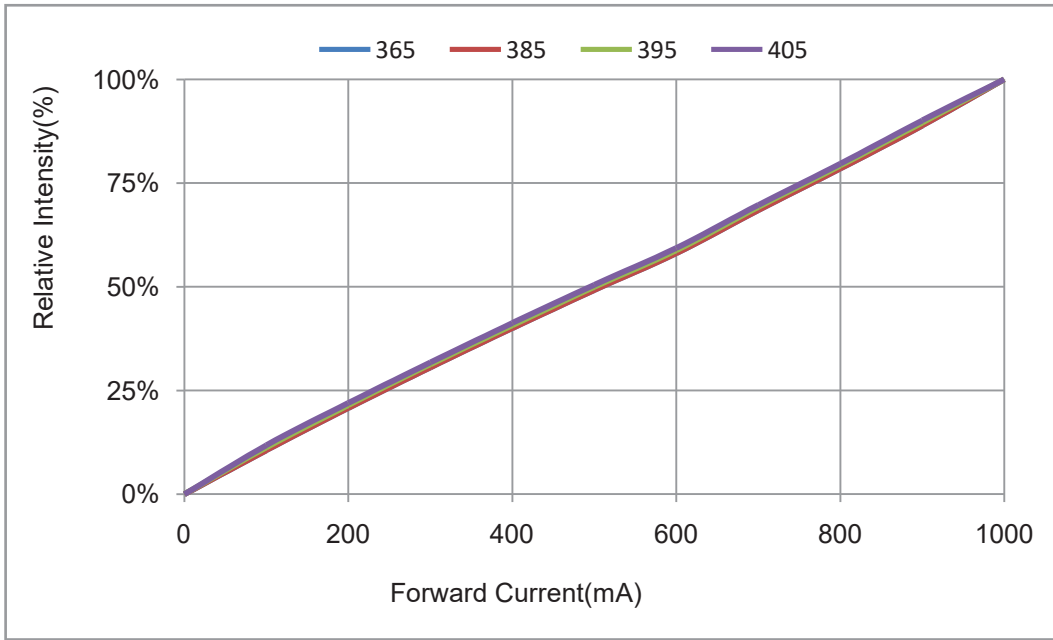

Fig.2- Forward Current Vs. Relative Power 正向电流与相对光功率特性曲线



ChromeLED Corp. reserves the right to make changes at any time in order to supply the best product possible. The most current version of this document will always be available at: www.chromeled.com

OPTICAL CHARACTERISTIC CURVES

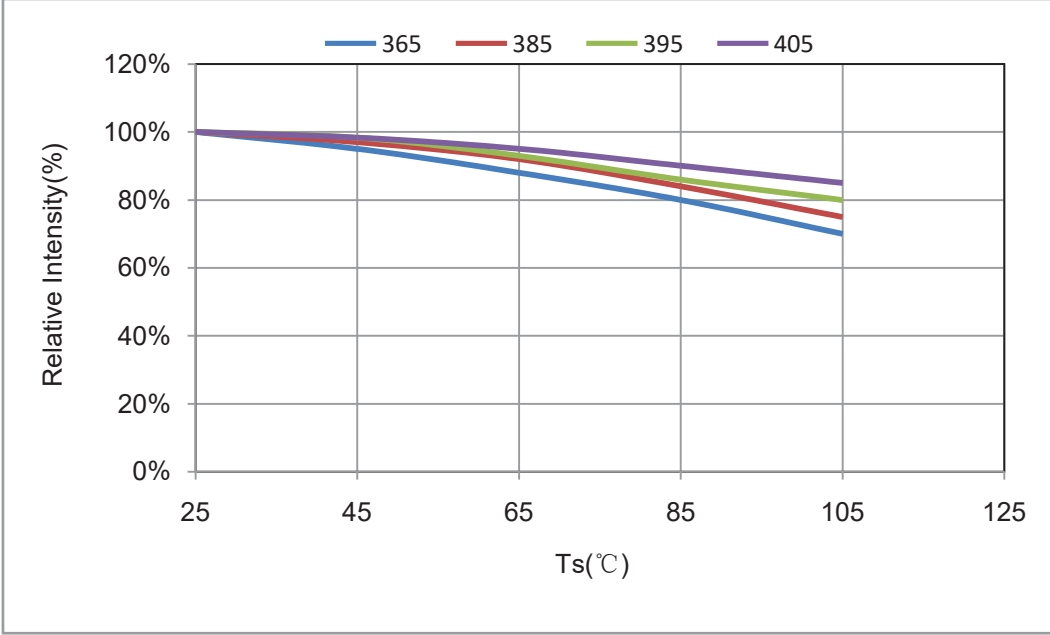

Fig.3-Solder Temperature VS. Relative Power 焊盘温度与相对光功率曲线

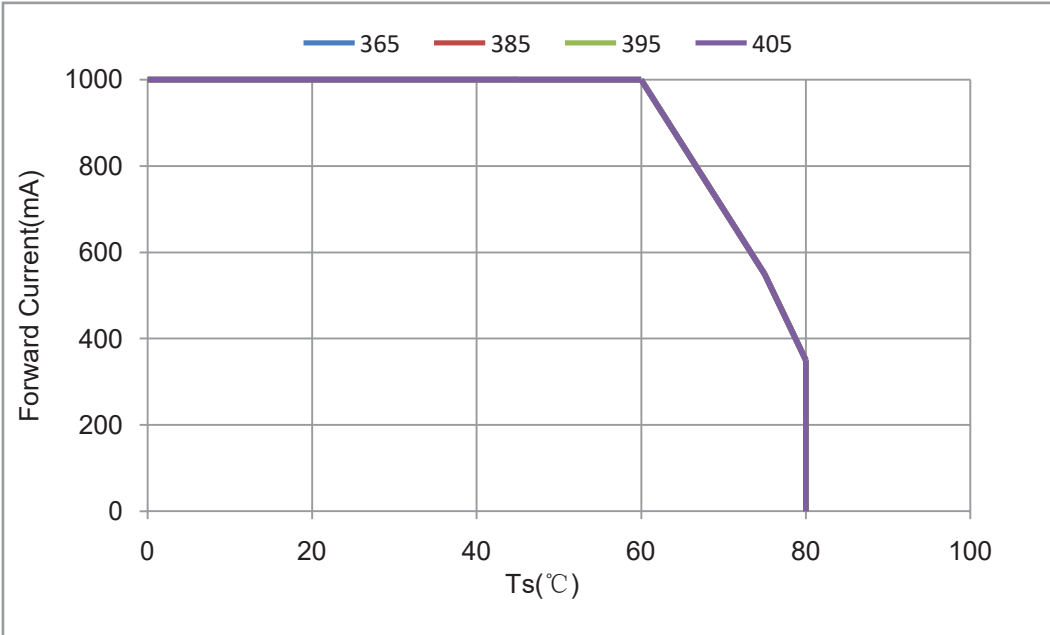



Fig.4-Ts Temperature VS. Forward Current 焊盘温度与正向电流特性曲线



ChromeLED Corp. reserves the right to make changes at any time in order to supply the best product possible. The most current version of this document will always be available at: www.chromeled.com

OPTICAL CHARACTERISTIC CURVES

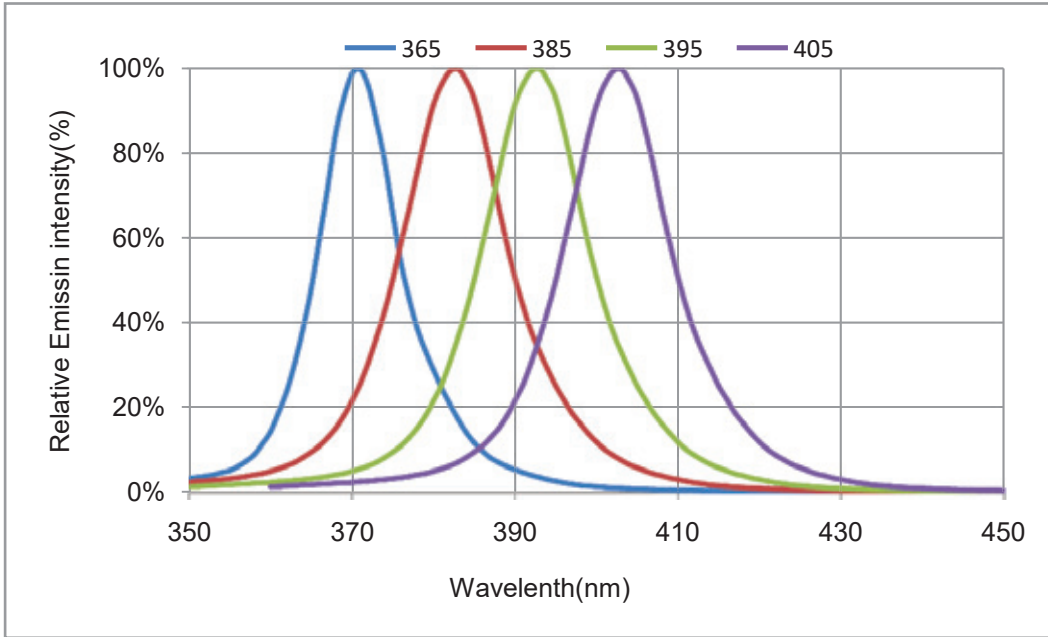

Fig.5-Spectrum Distribution 光谱分布特性曲线

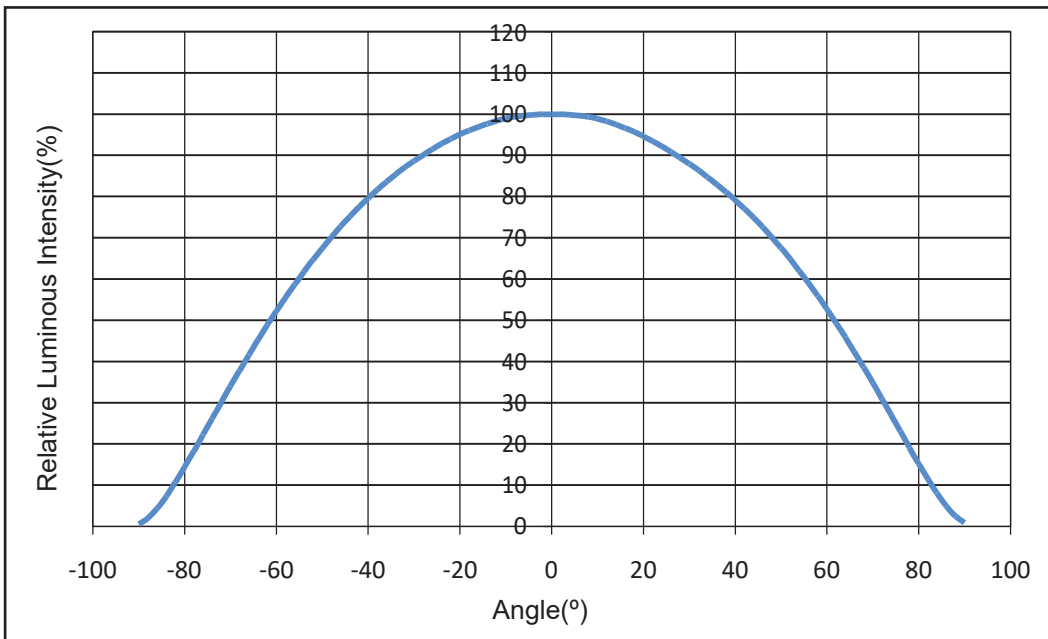

Fig.6- Radiation Diagram 辐射特性曲线



ChromeLED Corp. reserves the right to make changes at any time in order to supply the best product possible. The most current version of this document will always be available at: www.chromeled.com

PACKAGING SPECIFICATION

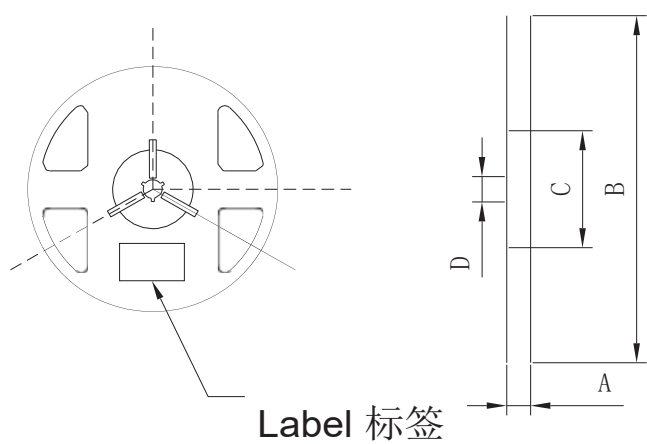
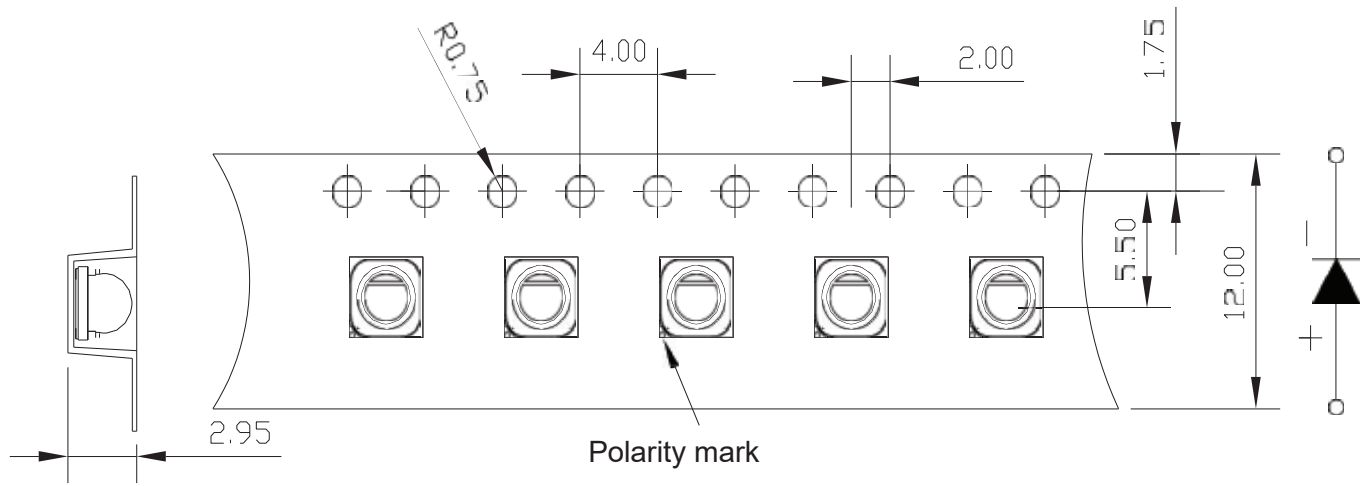

Table 2-1 Reel Dimension 卷盘尺寸

A	12±0.1mm
B	178±1mm
C	60±1mm
D	13.0±0.5mm



ChromeLED Corp. reserves the right to make changes at any time in order to supply the best product possible. The most current version of this document will always be available at: www.chromeled.com

SOLDERING CONDITIONS

- Recommended soldering profile

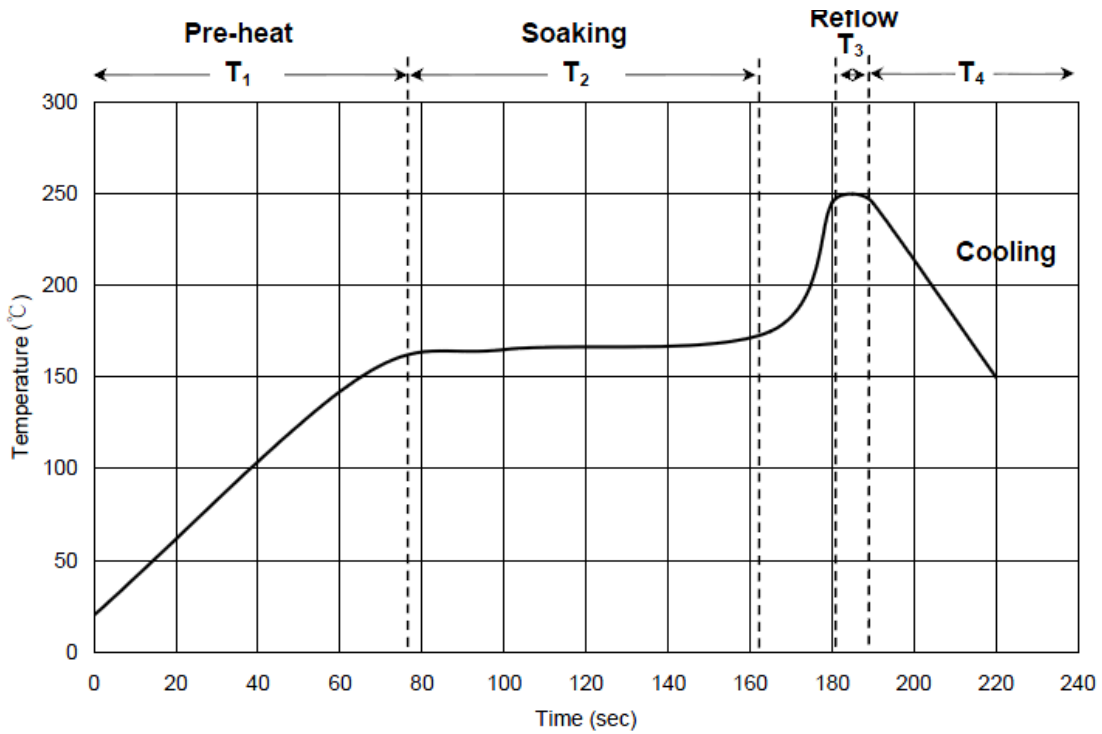

T1	Ramp up rate	1.0 ~ 3.0 °C/sec
	Pre-heat time	50~80 sec
T2	Soaking temperature	155~185°C
	Dwell time during soaking	60~120 sec
T3	Reflow temperature	240~250°C
	Reflow time	10 sec Max
	Ramp up rate during reflow	1.2~2.3 °C/sec
T4	Cooling	1.0~6.0 °C/sec

Notes:

1. Recommend using Sn96Ag3Cu0.5 lead free solder
2. Use alcohol-based cleaning solvents such as isopropyl alcohol to clean LED if necessary



ChromeLED Corp. reserves the right to make changes at any time in order to supply the best product possible. The most current version of this document will always be available at: www.chromeled.com