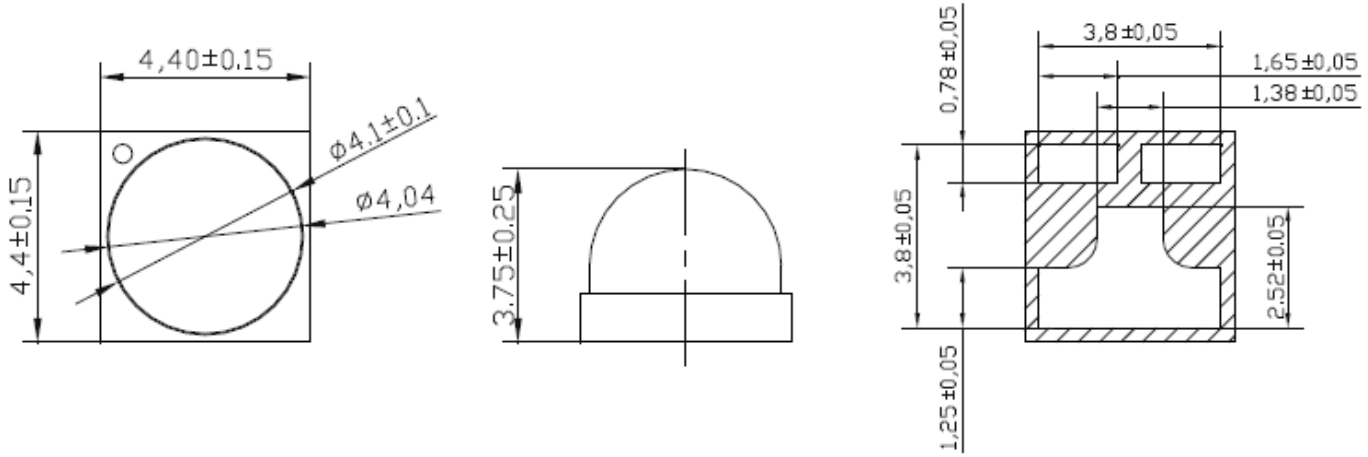
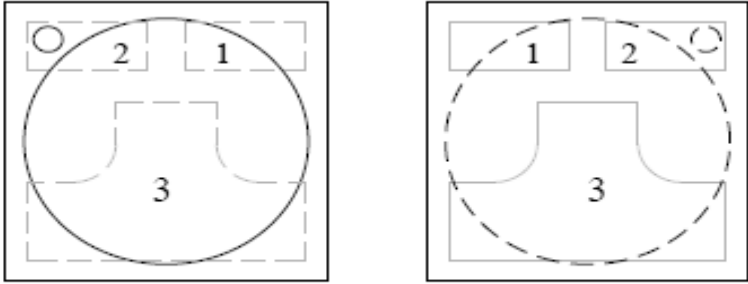

SPECIFICATIONS **CSHD1717UV280C-60**
MECHANICAL DIMENSIONS

PAD CONFIGURATION

TOP
BOTTOM

- Notes:
1. All dimensions are in millimeters (inches).
 2. Tolerance is $\pm 0.25\text{mm}$ (0.01") unless otherwise noted.
 3. Specifications are subject to change without notice.

Part Number	Chip Material	Color of Emission	Lens Type	Viewing Angle
CSHD1717UV280C-60	InGaN	UV	Water Clear	60°



ChromeLED Corp. reserves the right to make changes at any time in order to supply the best product possible. The most current version of this document will always be available at: www.chromeled.com

RECOMMENDED SOLDER PATTERN

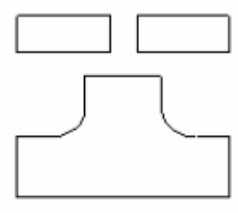
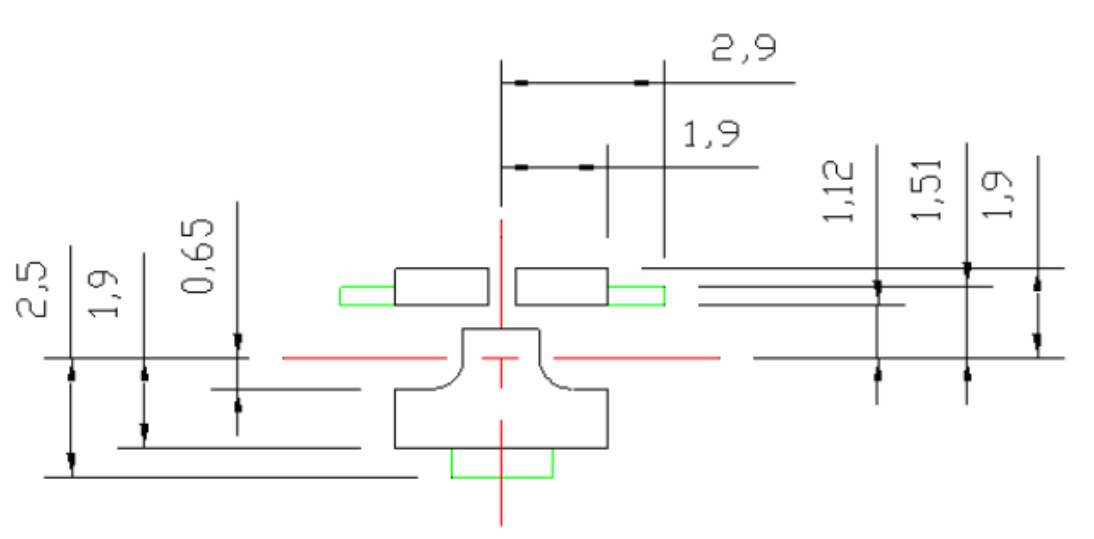

SOLDER MASK

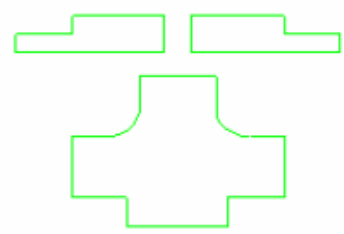

COPPER LAYER



ChromeLED Corp. reserves the right to make changes at any time in order to supply the best product possible. The most current version of this document will always be available at: www.chromeled.com

ABSOLUTE MAXIMUM RATINGS (TA=25°C)

Parameter	Symbol	Max Rating	Unit
Power Dissipation per Dice	PD	1.5	W
Continuous Forward Current per Dice	IF	150	mA
Thermal Resistance, Junction-Case	RTH, J-C1	15	°C/W
Operating Temperature	TOPR	-40~+60	°C
Storage Temperature	TSTG	-40~+100	°C

OPTICAL-ELECTRICAL CHARACTERISTICS (TA=25°C)

Characteristic	Symbol	Condition	Value			Unit
			Min.	Type.	Max.	
Forward Voltage per Dice	VF	IF = 150mA	-	8	10	V
Peak Wavelength per Dice	λP		275	-	285	nm
Radiant Flux	ΦE		8	10	-	mW
Viewing Angle	2θ 1/2		-	60	-	Deg
Spectra Half-Width	Δλ				15	-

*Tolerance of viewing angle: -10 / +5 deg.



ChromeLED Corp. reserves the right to make changes at any time in order to supply the best product possible. The most current version of this document will always be available at: www.chromeled.com

OPTICAL CHARACTERISTIC CURVES

Forward Current vs. Forward Voltage

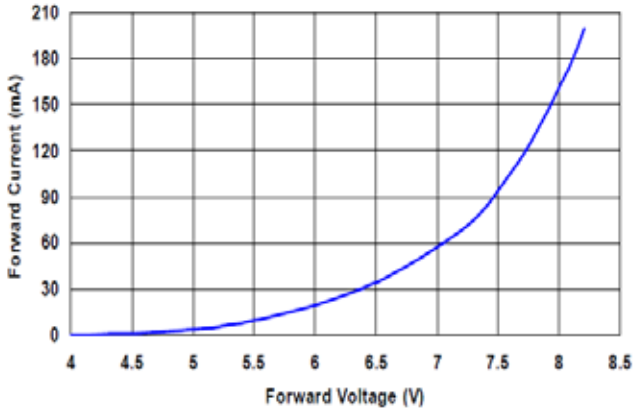

Relative Intensity vs. Forward Current

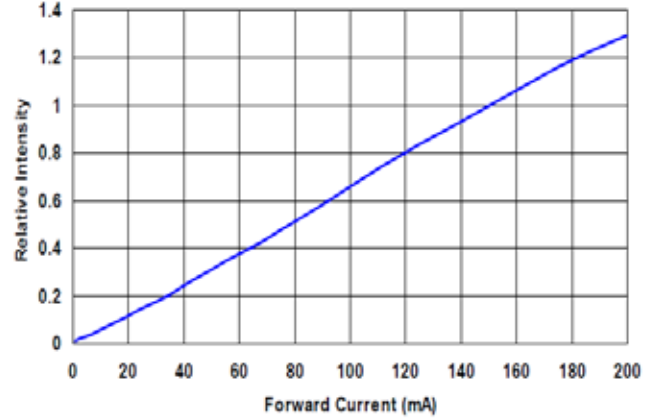

Spectral Power Distribution

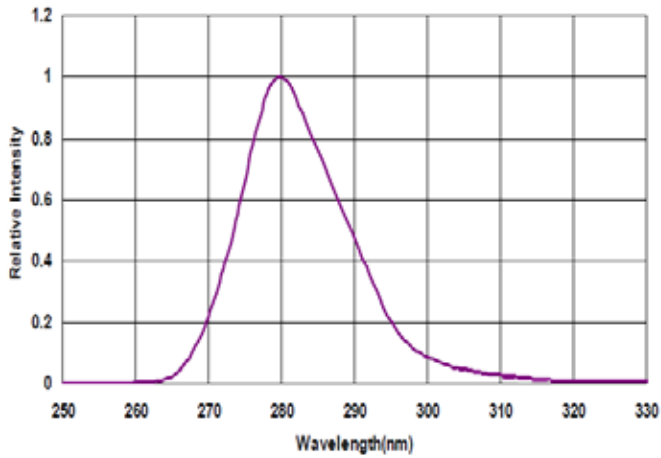

Typical Radiation Pattern

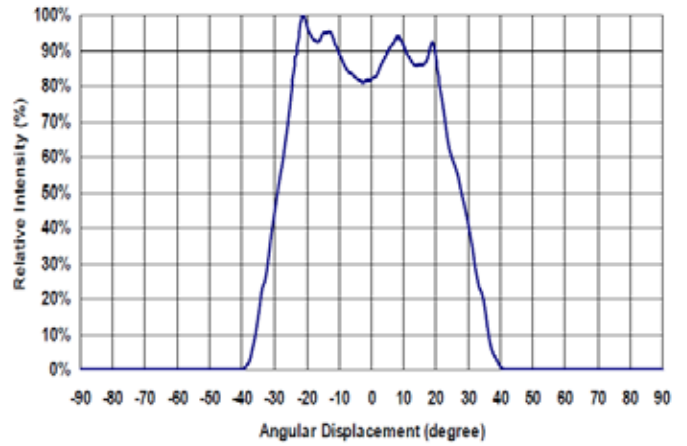

ChromeLED Corp. reserves the right to make changes at any time in order to supply the best product possible. The most current version of this document will always be available at: www.chromeled.com

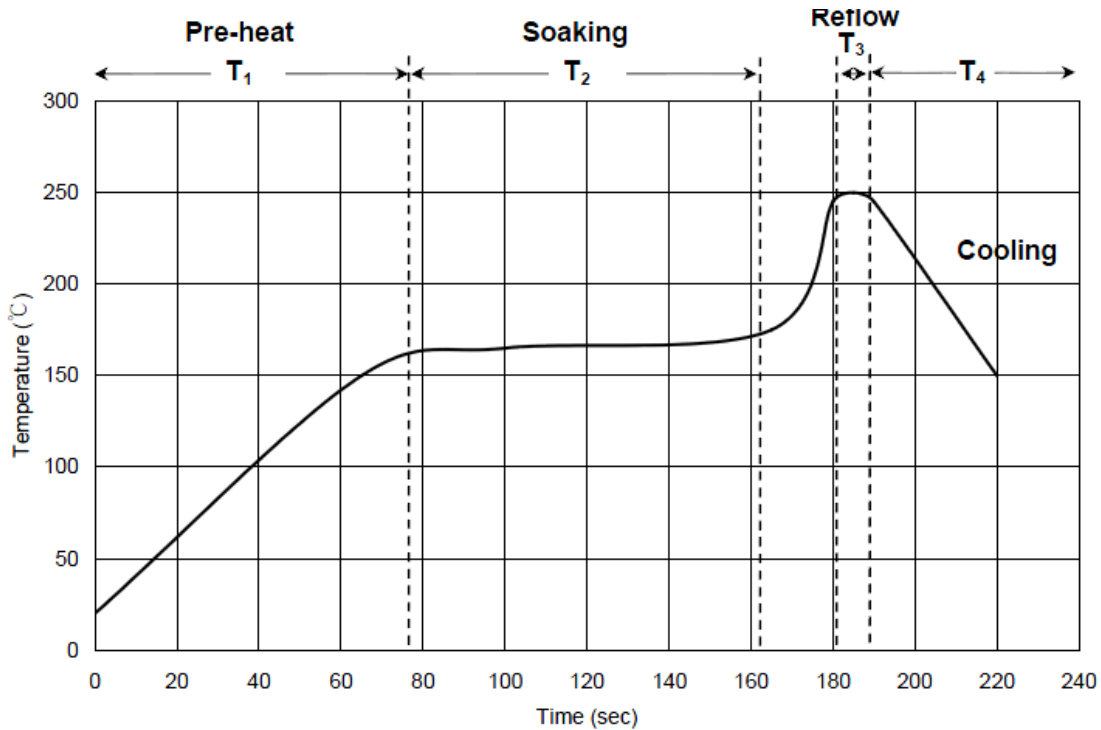
REFLOW SOLDERING CHARACTERISTICS

T ₁	Ramp up rate	1.0 ~ 3.0 °C/sec
	Pre-heat time	50~80 sec
T ₂	Soaking temperature	155~185°C
	Dwell time during soaking	60~120 sec
T ₃	Reflow temperature	240~250°C
	Reflow time	10 sec Max
	Ramp up rate during reflow	1.2~2.3 °C/sec
T ₄	Cooling	1.0~6.0 °C/sec

Notes:

1. Recommend using Sn96Ag3Cu0.5 lead free solder
2. Use alcohol-based cleaning solvents such as isopropyl alcohol to clean LED if necessary

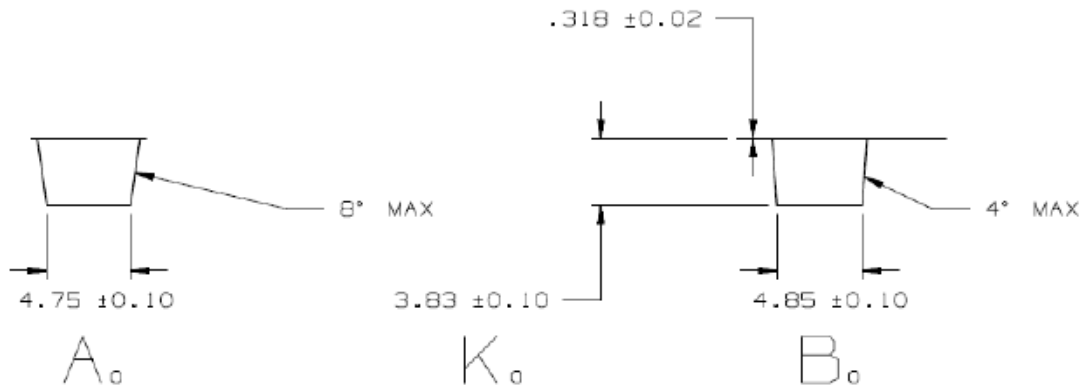
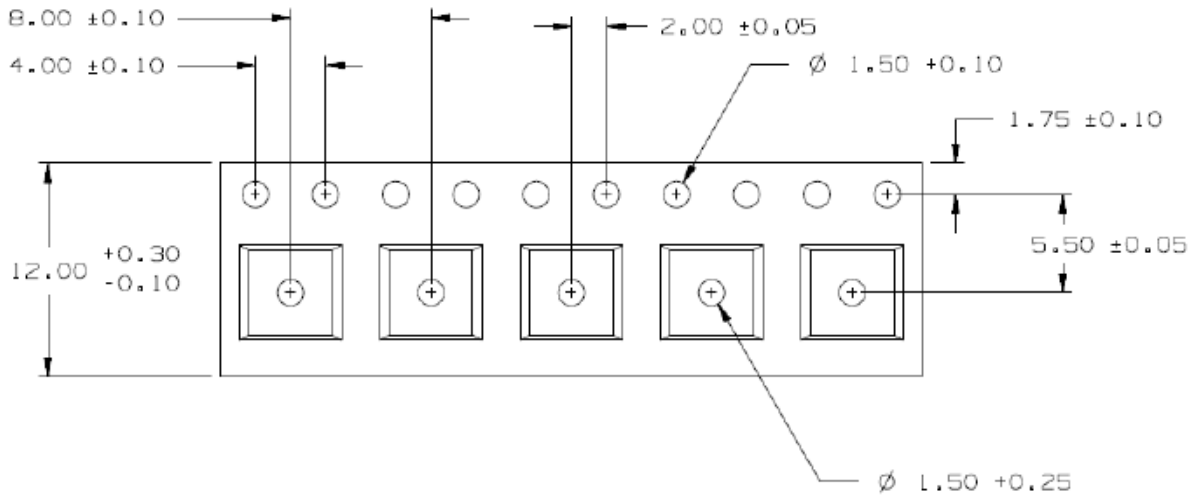

ChromeLED Corp. reserves the right to make changes at any time in order to supply the best product possible. The most current version of this document will always be available at: www.chromeled.com

PACKAGE DIMENSIONS (Unit: mm)

Notes:

1. All dimensions are in millimeter unless otherwise noted
2. Moisture proof bag
3. 1 Reel/ bag
4. Quantity: 650(max)/ Reel



ChromeLED Corp. reserves the right to make changes at any time in order to supply the best product possible. The most current version of this document will always be available at: www.chromeled.com