

SPECIFICATIONS **CSHD1717UV280C-30**
MECHANICAL DIMENSIONS

PAD	Function
1	Cathode
2	Anode
3	Thermal

- Notes:
1. All dimensions are in millimeters (inches).
 2. Tolerance is ± 0.25 mm (0.01") unless otherwise noted.
 3. Specifications are subject to change without notice.

Part Number	Chip Material	Color of Emission	Lens Type	Viewing Angle
CSHD1717UV280C-30	InGaN	UV	Water Clear	60°

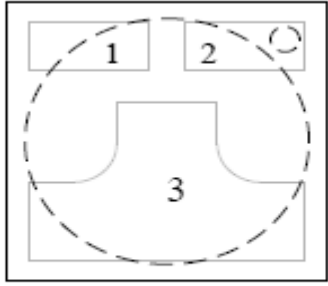
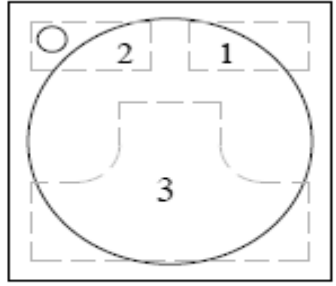
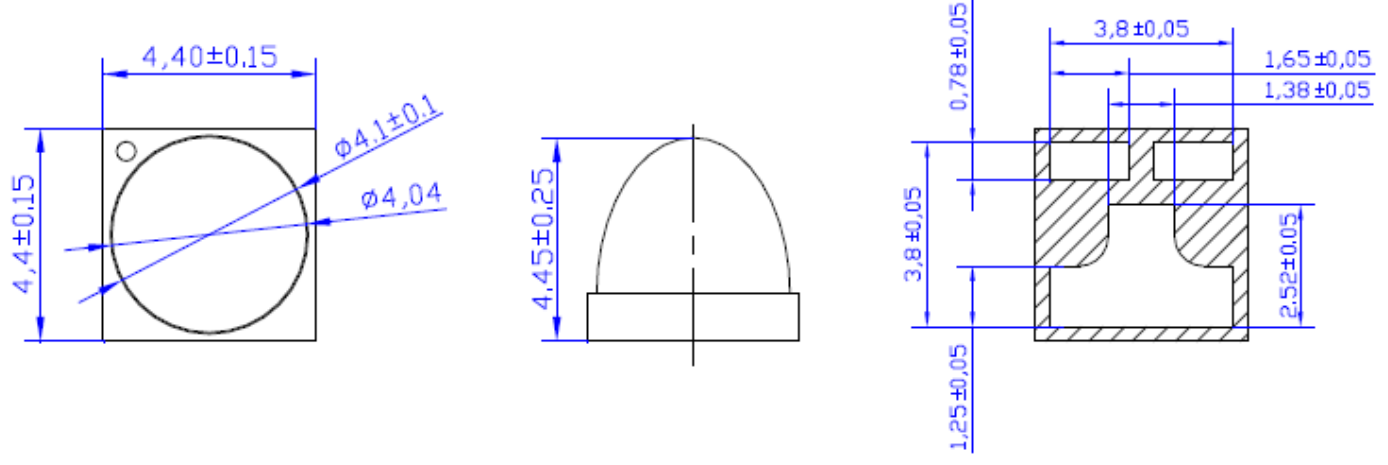

ChromeLED Corp. reserves the right to make changes at any time in order to supply the best product possible. The most current version of this document will always be available at: www.chromeled.com

RECOMMENDED SOLDER PATTERN

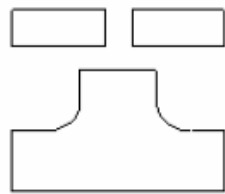
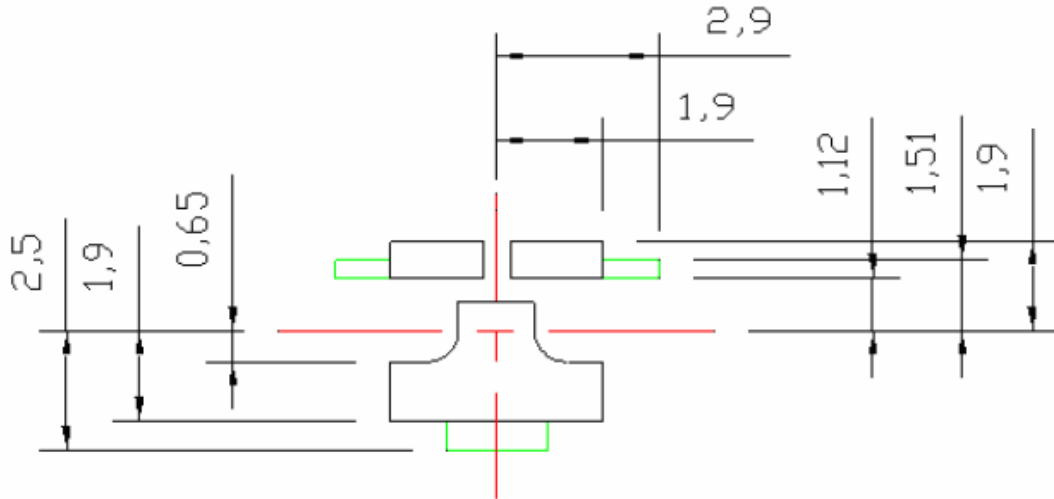

**SOLDER
MASK**

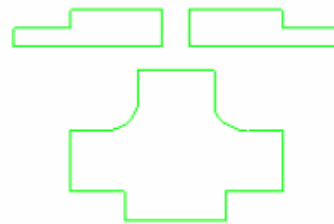

**COPPER
LAYER**



ChromeLED Corp. reserves the right to make changes at any time in order to supply the best product possible. The most current version of this document will always be available at: www.chromeled.com

ABSOLUTE MAXIMUM RATINGS (TA=25°C)

Parameter	Symbol	Max Rating	Unit
Power Dissipation per Dice	P _D	1.5	W
Continuous Forward Current per Dice	I _F	150	mA
Thermal Resistance, Junction-Case	R _{TH, J-C1}	15	°C/W
Operating Temperature	T _{OPR}	-40~+60	°C
Storage Temperature	T _{STG}	-40~+100	°C

OPTICAL-ELECTRICAL CHARACTERISTICS (TA=25°C)

Characteristic	Symbol	Condition	Value			Unit
			Min.	Type.	Max.	
Forward Voltage per Dice	V _F	I _F = 150mA	-	8	10	V
Peak Wavelength per Dice	λ _P		275	-	285	nm
Radiant Flux	Φ _E		8	10	-	mW
Viewing Angle	2θ 1/2		-	30	-	Deg
Spectra Half-Width	Δλ			15	-	nm

*Tolerance of viewing angle: -10 / +5 deg.



ChromeLED Corp. reserves the right to make changes at any time in order to supply the best product possible. The most current version of this document will always be available at: www.chromeled.com

OPTICAL CHARACTERISTIC CURVES

TYPICAL ELECTRICAL-OPTICAL CHARACTERISTIC CURVES

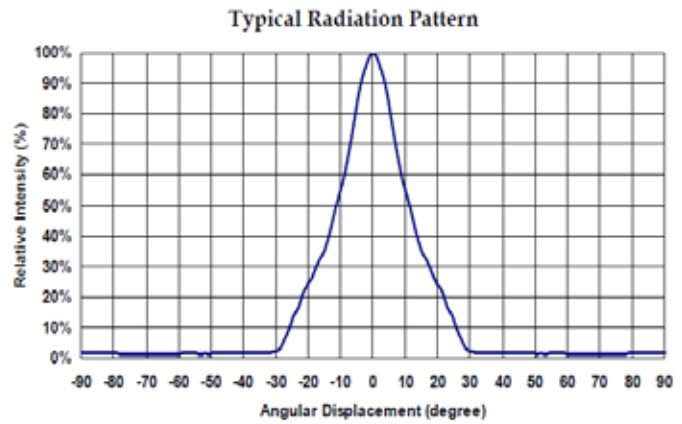
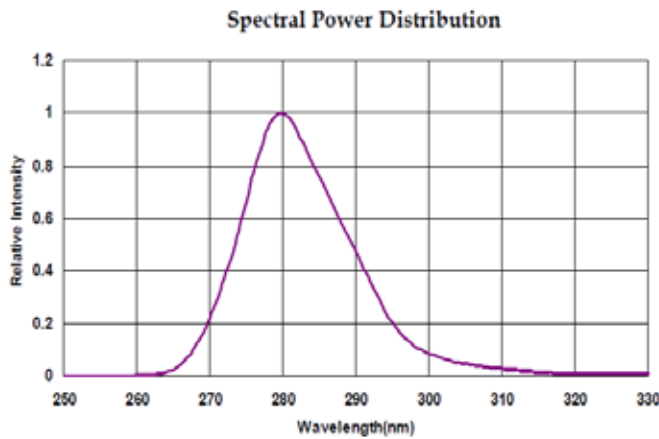
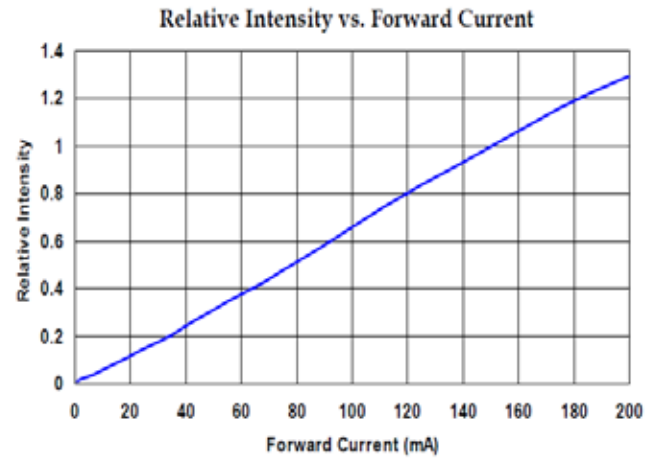
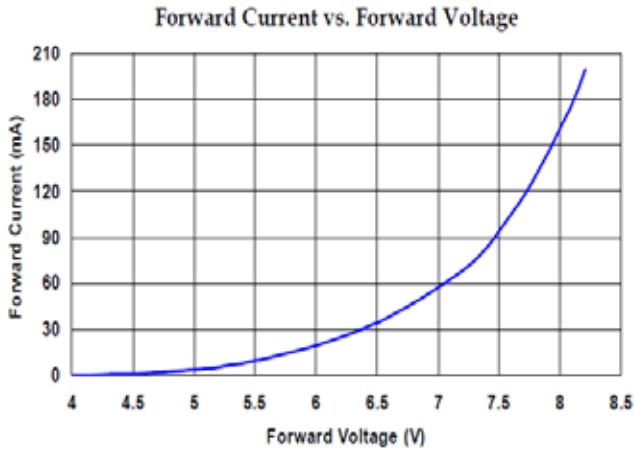

ChromeLED Corp. reserves the right to make changes at any time in order to supply the best product possible. The most current version of this document will always be available at: www.chromeled.com

REFLOW SOLDERING CHARACTERISTICS

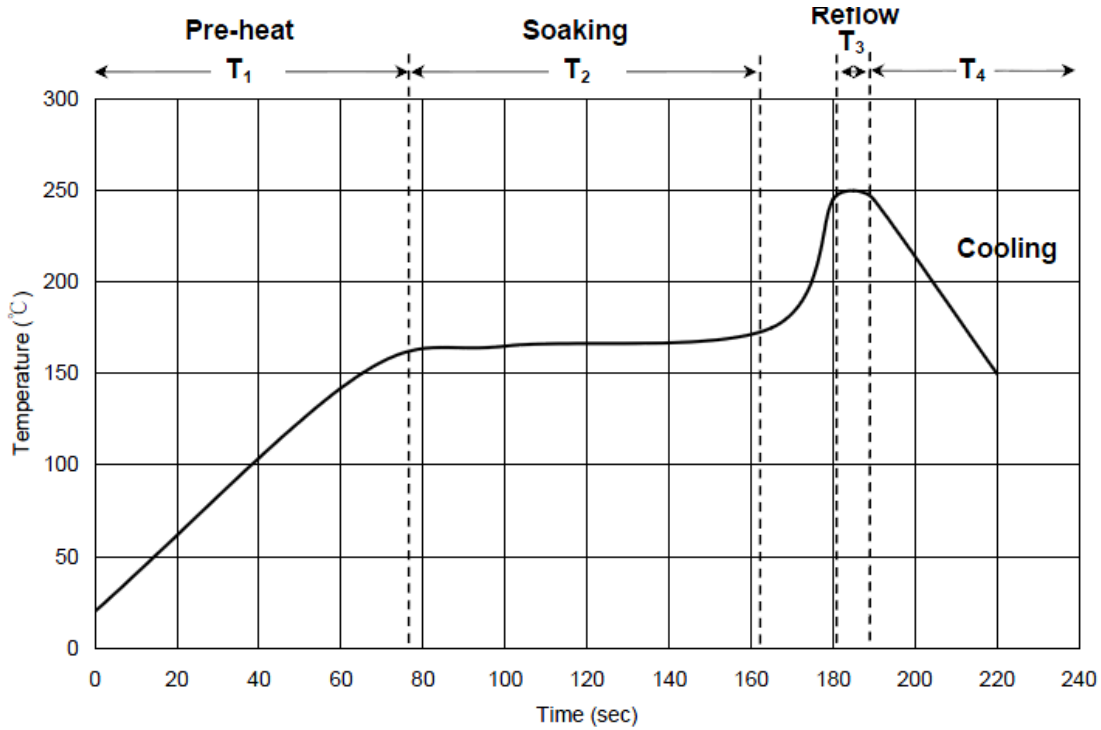

T ₁	Ramp up rate	1.0 ~ 3.0 °C/sec
	Pre-heat time	50~80 sec
T ₂	Soaking temperature	155~185°C
	Dwell time during soaking	60~120 sec
T ₃	Reflow temperature	240~250°C
	Reflow time	10 sec Max
	Ramp up rate during reflow	1.2~2.3 °C/sec
T ₄	Cooling	1.0~6.0 °C/sec

Notes:

1. Recommend using Sn96Ag3Cu0.5 lead free solder
2. Use alcohol-based cleaning solvents such as isopropyl alcohol to clean LED if necessary

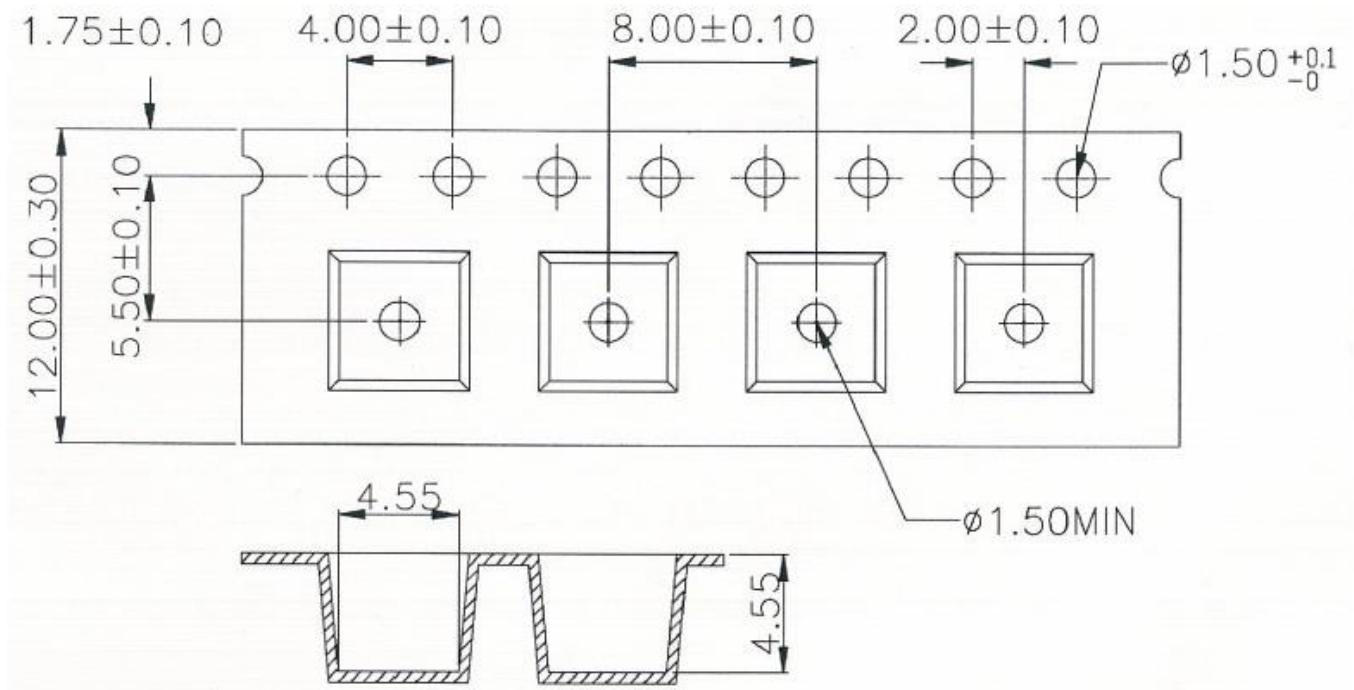

ChromeLED Corp. reserves the right to make changes at any time in order to supply the best product possible. The most current version of this document will always be available at: www.chromeled.com

PACKAGE DIMENSIONS (Unit: mm)
TAPE DIMENSION

Notes:

1. All dimensions are in millimeter unless otherwise noted
2. Moisture proof bag
3. 1 Reel/ bag
4. Quantity: 500(max)/ Reel



ChromeLED Corp. reserves the right to make changes at any time in order to supply the best product possible. The most current version of this document will always be available at: www.chromeled.com