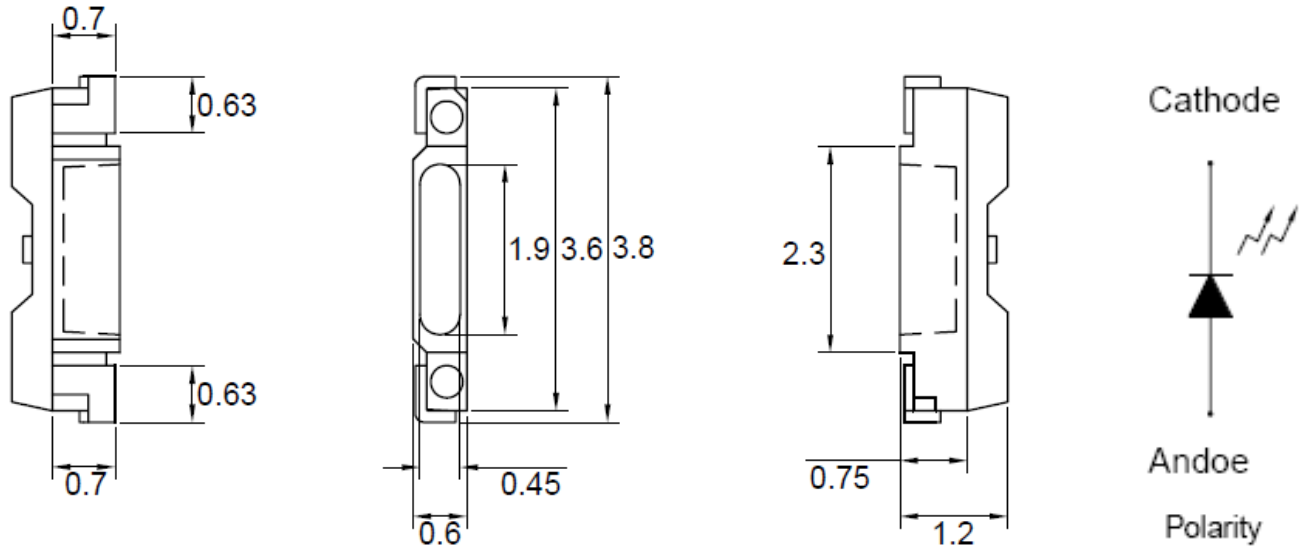
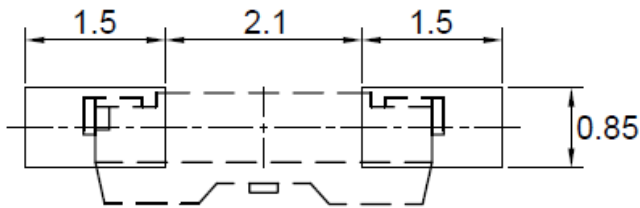

**SPECIFICATION** **CSPR155GT2C**
**PACKAGE OUTLINES**

**RECOMMEND PAD LAYOUT**

**Notes:**

1. All dimensions are in millimeters (inches).
2. Tolerance is  $\pm 0.25\text{mm}$  (0.01") unless otherwise noted.
3. Specifications are subject to change without notice.

| Part Number | Chip Material | Color of Emission | Lens Type   | Viewing Angle |
|-------------|---------------|-------------------|-------------|---------------|
| CSPR155GT2C | InGaN         | Green             | Water Clear | 120°          |



ChromeLED Corp. reserves the right to make changes at any time in order to supply the best product possible. The most current version of this document will always be available at: [www.chromeled.com](http://www.chromeled.com)

**ABSOLUTE MAXIMUM RATINGS**
**(TA=25°C)**

| Parameter                                  | Symbol           | Max Rating              | Unit |
|--|------------------|-------------------------|------|
| Forward Current                            | I <sub>F</sub>   | 30                      | mA   |
| Reverse Current @ 5V                       | I <sub>R</sub>   | 50                      | μA   |
| Power Dissipation                          | P <sub>d</sub>   | 120                     | mW   |
| Operating Temperature Range                | T <sub>OP</sub>  | -20~+80                 | °C   |
| Storage Temperature Range                  | T <sub>STG</sub> | -30~+100                | °C   |
| Peak Pulsing Current (1/10 duty f = 10KHz) | I <sub>FP</sub>  | 100                     | mA   |
| Soldering Temperature                      | T <sub>SOL</sub> | Max 260°C for 5 sec Max |      |

**OPTICAL-ELECTRICAL CHARACTERISTICS**
**(TA=25°C)**

| Parameter                           | Symbol            | Test Condition        | Value |     |     | Unit |
|-------------------------------------|-------------------|-----------------------|-------|-----|-----|------|
|                                     |                   |                       | Min   | Typ | Max |      |
| Luminous Intensity                  | I <sub>v</sub>    | I <sub>F</sub> = 20mA | 500   | 800 | -   | mcd  |
| Forward Voltage                     | V <sub>F</sub>    | I <sub>F</sub> = 20mA | -     | 3.3 | 4.0 | V    |
| Reverse Leakage Current             | I <sub>R</sub>    | V <sub>R</sub> = 5V   | -     | -   | 10  | μA   |
| Viewing Angle at 50% I <sub>v</sub> | 2θ <sub>1/2</sub> | I <sub>F</sub> = 20mA | -     | 120 | -   | Deg  |
| Peak Wavelength                     | λ <sub>P</sub>    | I <sub>F</sub> = 20mA | -     | 520 | -   | nm   |
| Dominant Wavelength                 | λ <sub>D</sub>    | I <sub>F</sub> = 20mA | -     | 525 | -   | nm   |

\*Tolerance of viewing angle: -10 / +5 deg.



ChromeLED Corp. reserves the right to make changes at any time in order to supply the best product possible. The most current version of this document will always be available at: [www.chromeled.com](http://www.chromeled.com)

## OPTICAL CHARACTERISTIC CURVES

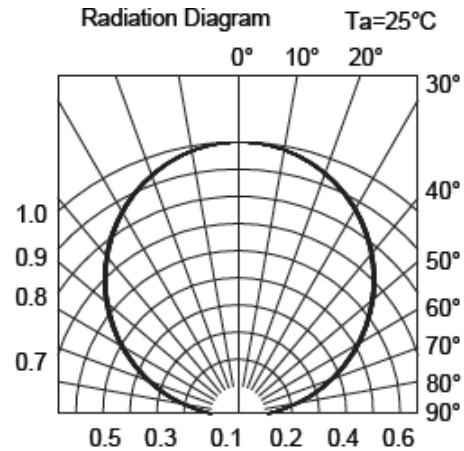
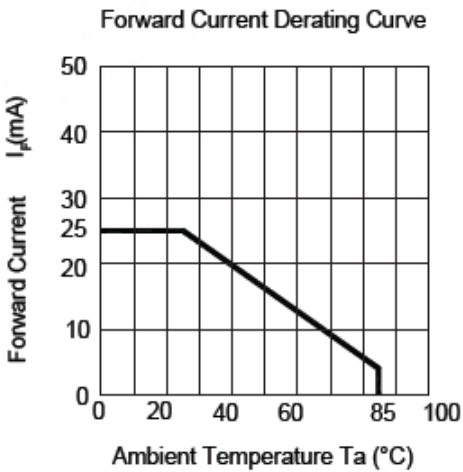
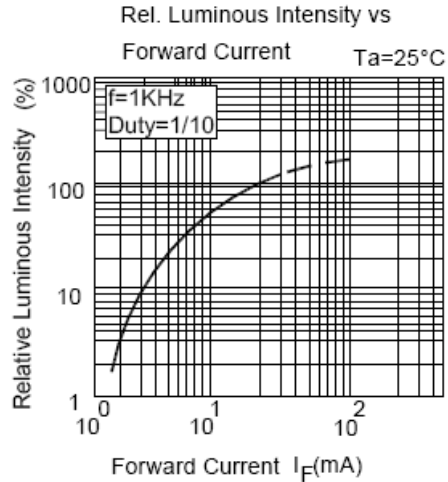
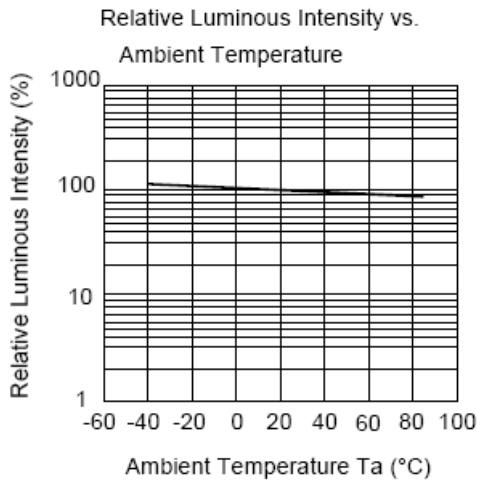
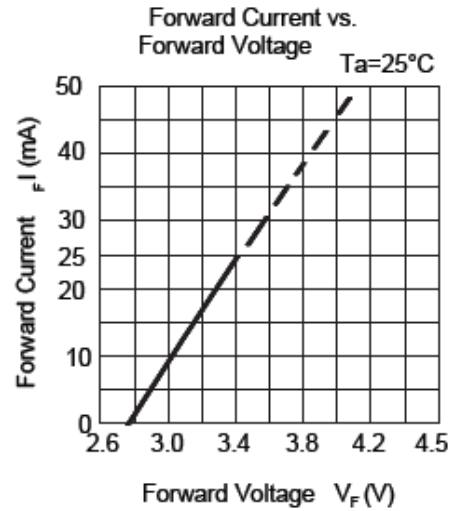
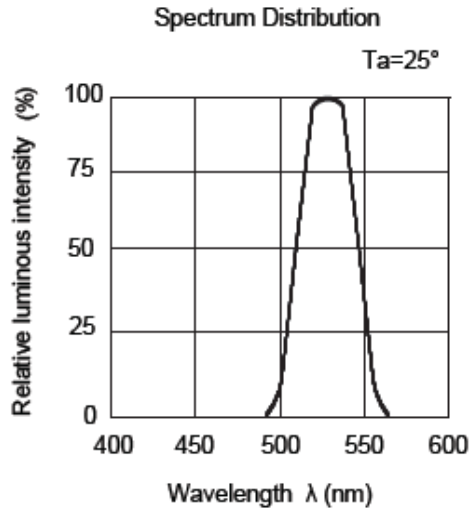

ChromeLED Corp. reserves the right to make changes at any time in order to supply the best product possible. The most current version of this document will always be available at: [www.chromeled.com](http://www.chromeled.com)

## PACKAGING SPECIFICATION

### CARRIER TAPE DIMENSION

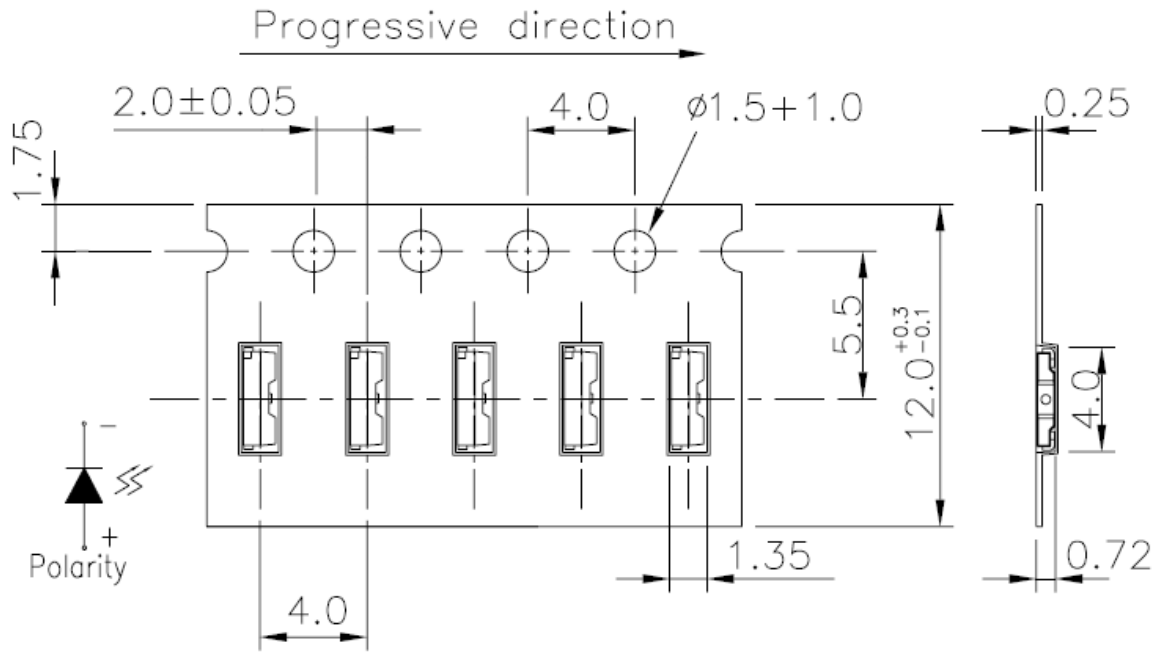

Note: The tolerances unless mentioned are  $\pm 0.1$ mm, Angle  $\pm 0.5$ ; Unit=mm

### REEL DIMENSIONS

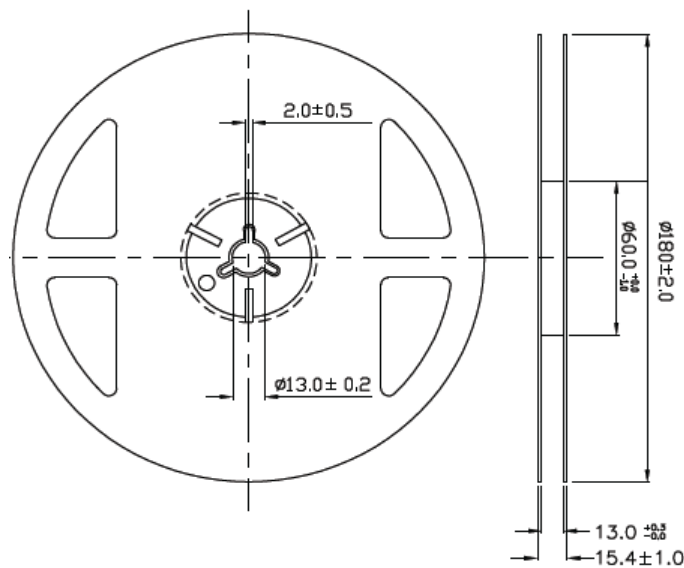

- Notes:
1. 250/500/1000/2000 pieces per reel
  2. Tolerance unless mentioned is  $\pm 0.1$ mm; Unit=mm



ChromeLED Corp. reserves the right to make changes at any time in order to supply the best product possible. The most current version of this document will always be available at: [www.chromeled.com](http://www.chromeled.com)

# SOLDERING CONDITIONS

## RECOMMENDED Sn-PB IR-Reflow Soldering Profile



## RECOMMENDED Pb-Free Soldering Profile

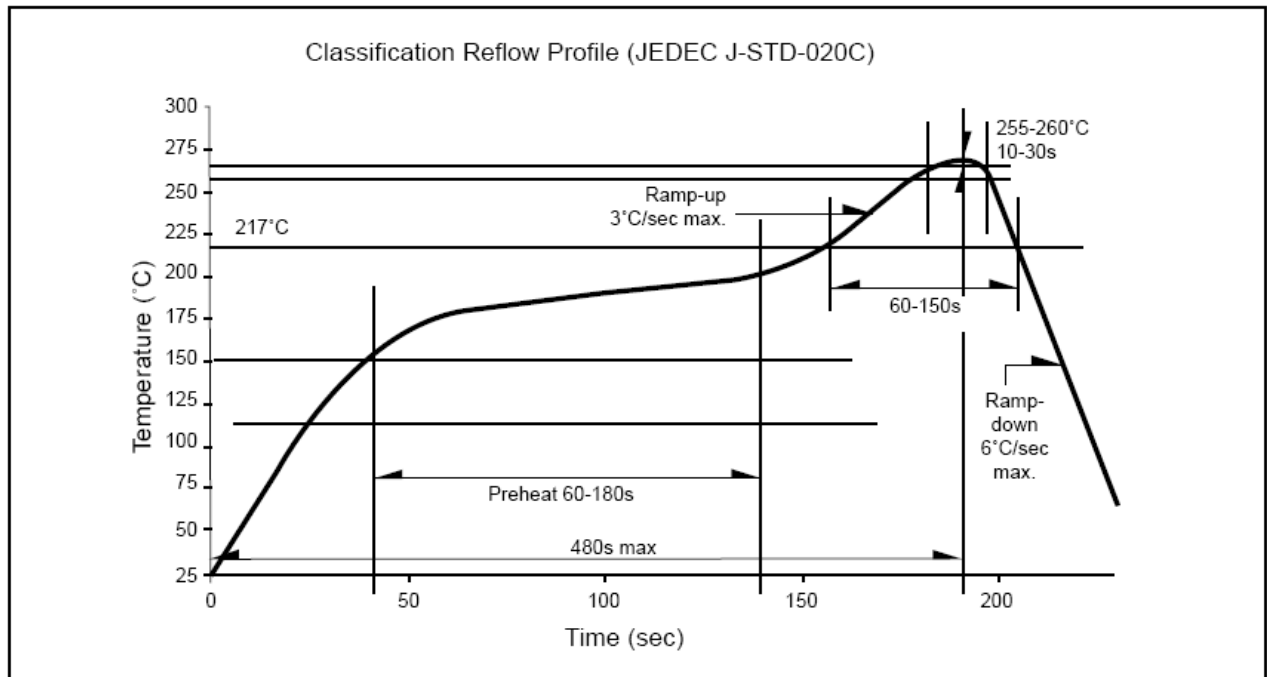

ChromeLED Corp. reserves the right to make changes at any time in order to supply the best product possible. The most current version of this document will always be available at: [www.chromeled.com](http://www.chromeled.com)