

**SPECIFICATION** **CSRB125R2G2C**

**PACKAGE OUTLINES**

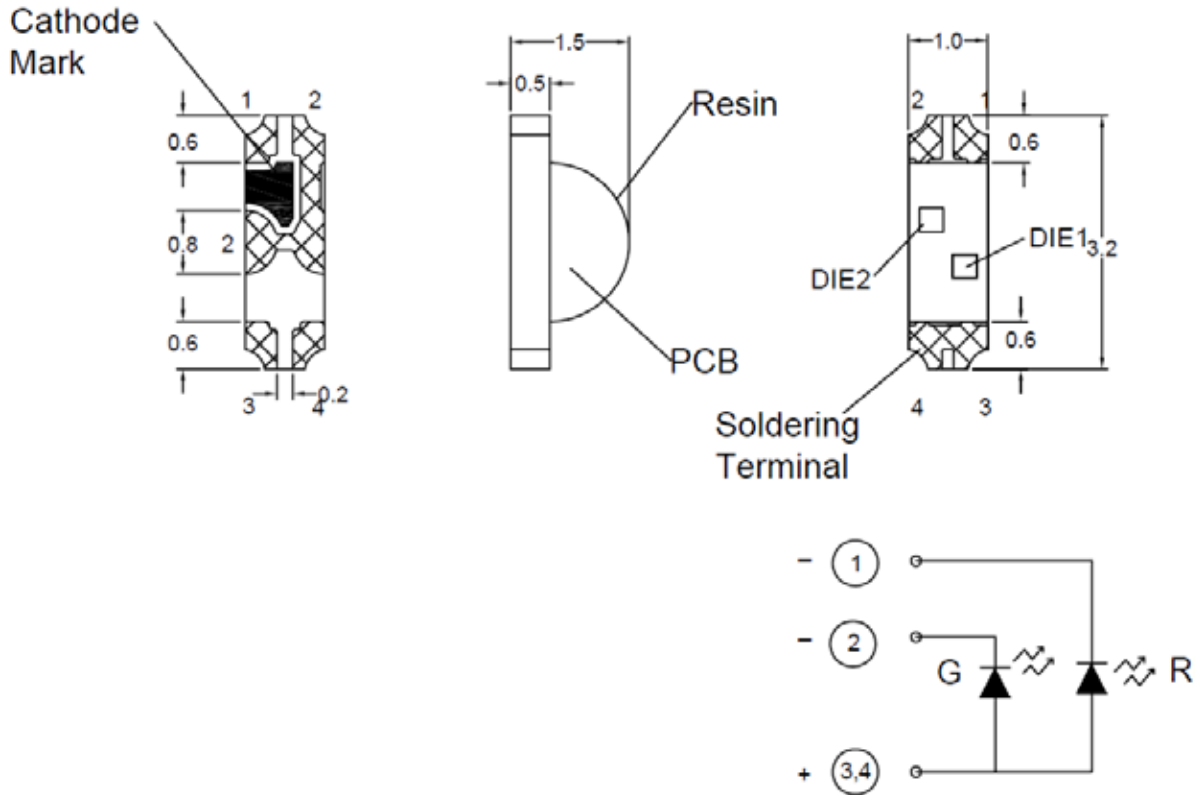

- Notes:
1. All dimensions are in millimeters (inches).
  2. Tolerance is  $\pm 0.25\text{mm}$  (0.01") unless otherwise noted.
  3. Specifications are subject to change without notice.

Part Number	Chip Material	Color of Emission	Lens Type	Viewing Angle
CSRB125R2G2C	InGaAlP	Red	Water Clear	120°
	InGaAlP	Green		



ChromeLED Corp. reserves the right to make changes at any time in order to supply the best product possible. The most current version of this document will always be available at: [www.chromeled.com](http://www.chromeled.com)

**ABSOLUTE MAXIMUM RATINGS**
**(TA=25°C)**

Parameter	Symbol	Max Rating		Unit
		R	G	
Forward Current	I <sub>F</sub>	30	30	mA
Reverse Current @ 5V	I <sub>R</sub>	10	10	μA
Power Dissipation	P <sub>d</sub>	72	78	mW
Operating Temperature Range	T <sub>OP</sub>	-40~+85		°C
Storage Temperature Range	T <sub>STG</sub>	-40~+100		°C
Peak Pulsing Current (1/10 duty f = 10KHz)	I <sub>FP</sub>	90	60	mA
Soldering Temperature	T <sub>SOL</sub>	Max 260°C for 5 sec Max		

**OPTICAL-ELECTRICAL CHARACTERISTICS**
**(TA=25°C)**

Parameter	Symbol	Test Condition	Color	Value			Unit
				Min	Typ	Max	
Luminous Intensity	I <sub>v</sub>	I <sub>F</sub> = 20mA	R	32	70	-	mcd
			G	20	40		
Forward Voltage	V <sub>F</sub>	I <sub>F</sub> = 20mA	R	-	2.0	2.4	V
			G	-	2.1	2.6	
Viewing Angle at 50% I <sub>v</sub>	2θ <sub>1/2</sub>	I <sub>F</sub> = 20mA	-	-	120	-	Deg
Peak Wavelength	λ <sub>P</sub>	I <sub>F</sub> = 20mA	R	-	635	-	nm
			G		574		
Dominant Wavelength	λ <sub>D</sub>	I <sub>F</sub> = 20mA	R	-	630	-	nm
			G		570		

\*Tolerance of viewing angle: -10 / +5 deg.



ChromeLED Corp. reserves the right to make changes at any time in order to supply the best product possible. The most current version of this document will always be available at: [www.chromeled.com](http://www.chromeled.com)

## OPTICAL CHARACTERISTIC CURVES - RED

Fig.1 Forward current vs. Forward Voltage

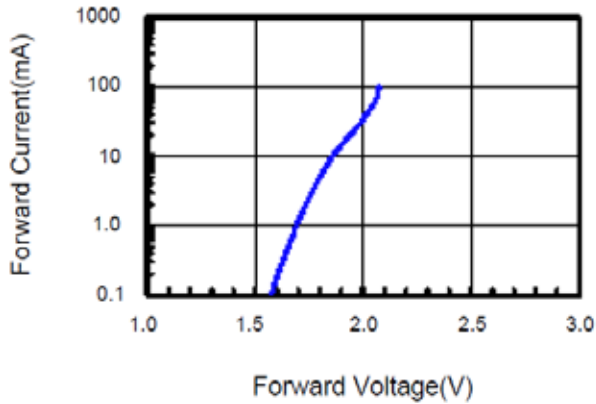

Fig.2 Relative Intensity vs. Forward Current

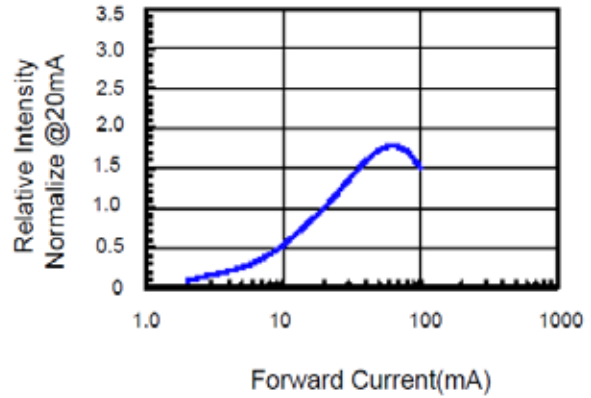

Fig.3 Forward Voltage vs. Temperature

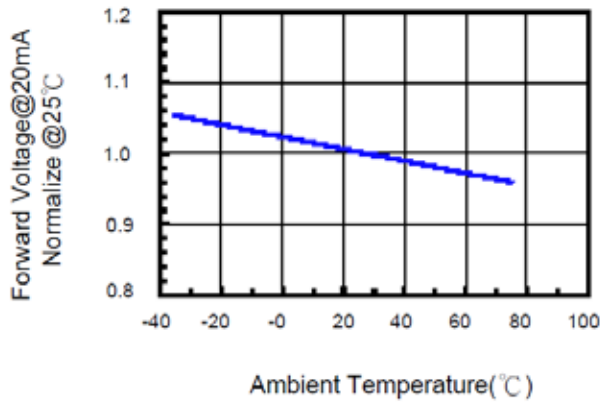

Fig.4 Relative Intensity vs. Temperature

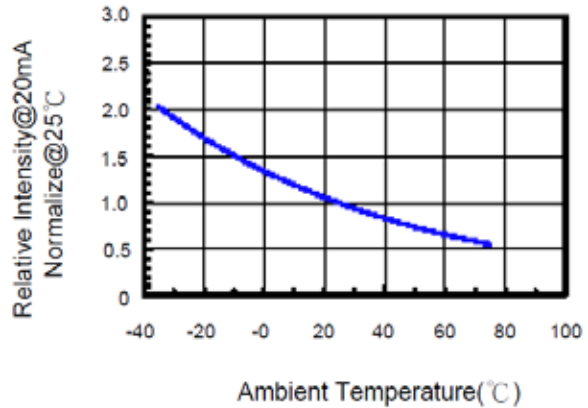

Fig.5 Relative Intensity vs. Wavelength

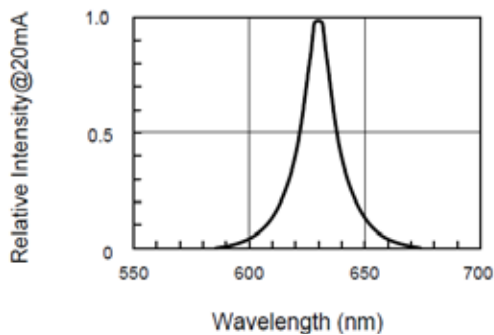
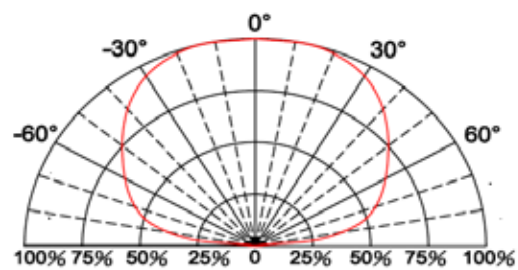

Fig.6 Directive Radiation



ChromeLED Corp. reserves the right to make changes at any time in order to supply the best product possible. The most current version of this document will always be available at: [www.chromeled.com](http://www.chromeled.com)

## OPTICAL CHARACTERISTIC CURVES - GREEN

Fig.1 Forward current vs. Forward Voltage

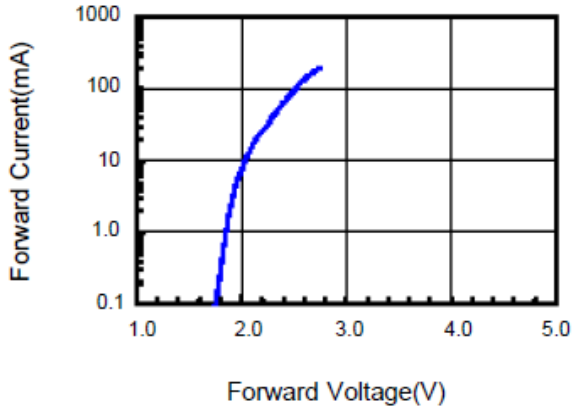

Fig.2 Relative Intensity vs. Forward Current

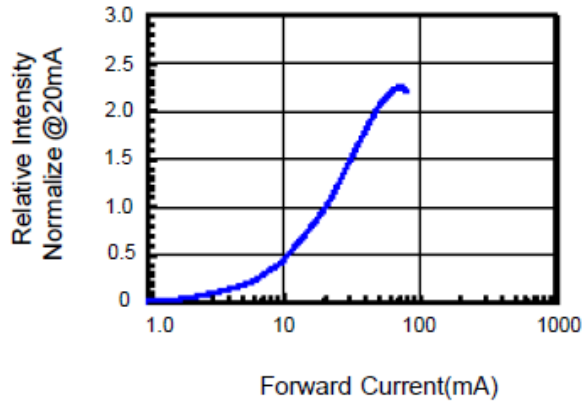

Fig.3 Forward Voltage vs. Temperature

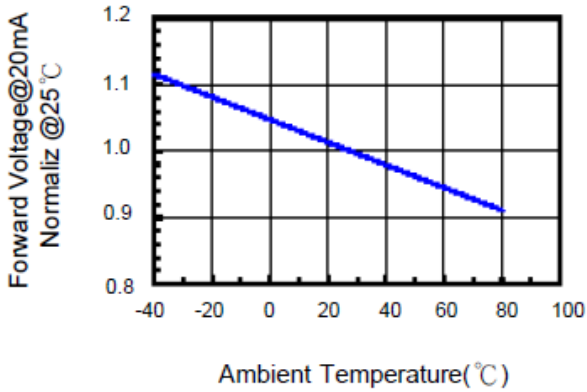

Fig.4 Relative Intensity vs. Temperature

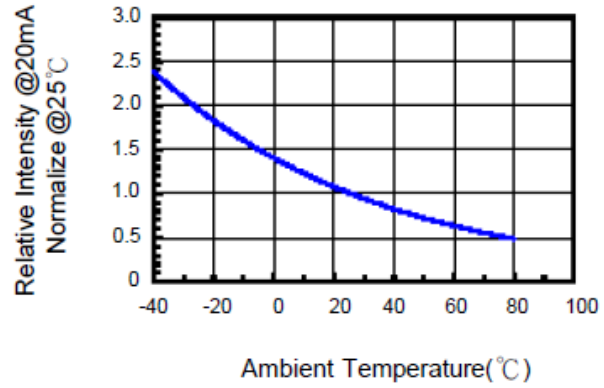

Fig.5 Relative Intensity vs. Wavelength

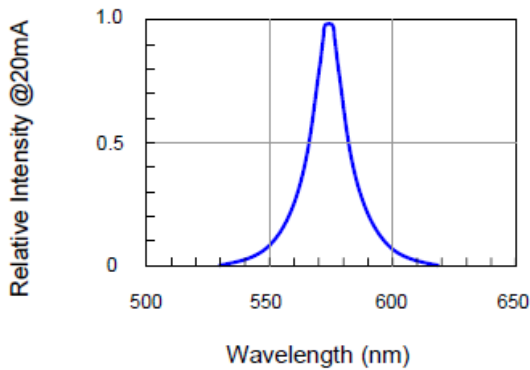
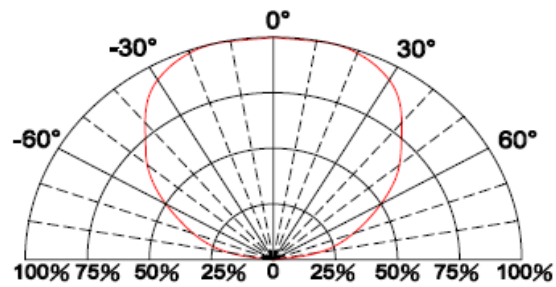

Fig.6 Directive Radiation



ChromeLED Corp. reserves the right to make changes at any time in order to supply the best product possible. The most current version of this document will always be available at: [www.chromeled.com](http://www.chromeled.com)

# SOLDERING CONDITIONS

## RECOMMENDED Sn-PB IR-Reflow Soldering Profile



## RECOMMENDED Pb-Free Soldering Profile

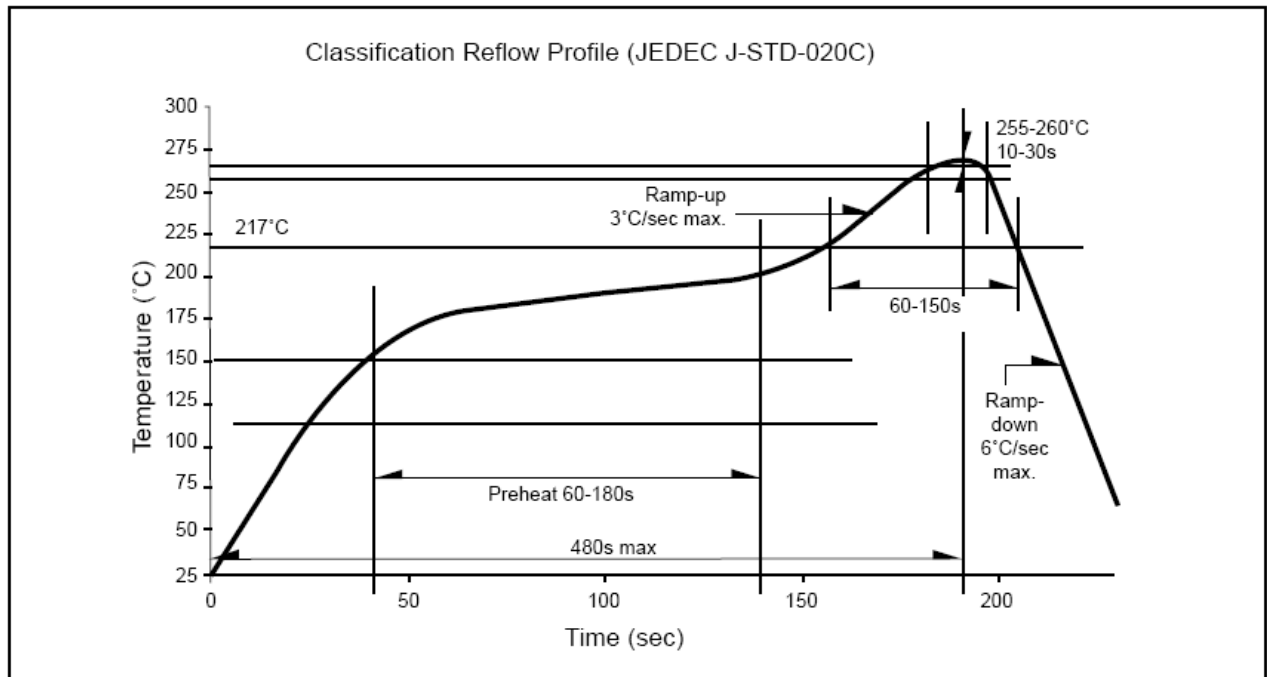

ChromeLED Corp. reserves the right to make changes at any time in order to supply the best product possible. The most current version of this document will always be available at: [www.chromeled.com](http://www.chromeled.com)

## REEL PACKAGING

### CARRIER TYPE DIMENSIONS

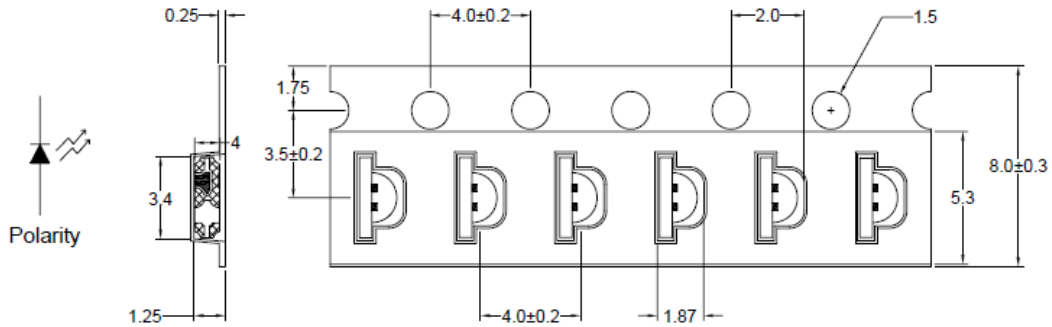

### PACKAGING SPECIFICATIONS

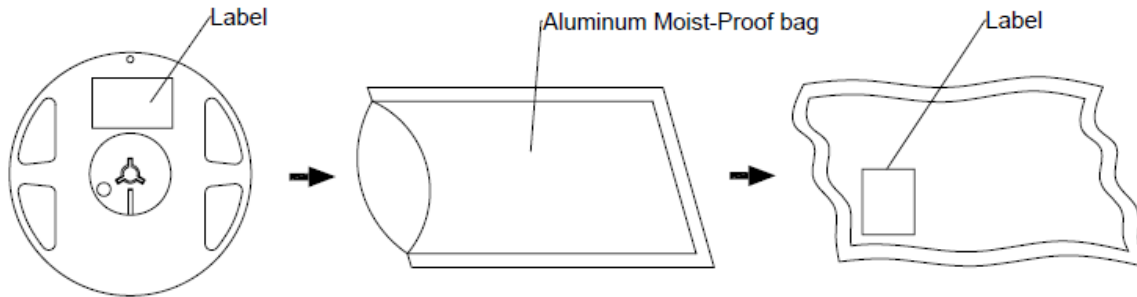

### REEL DIMENSIONS

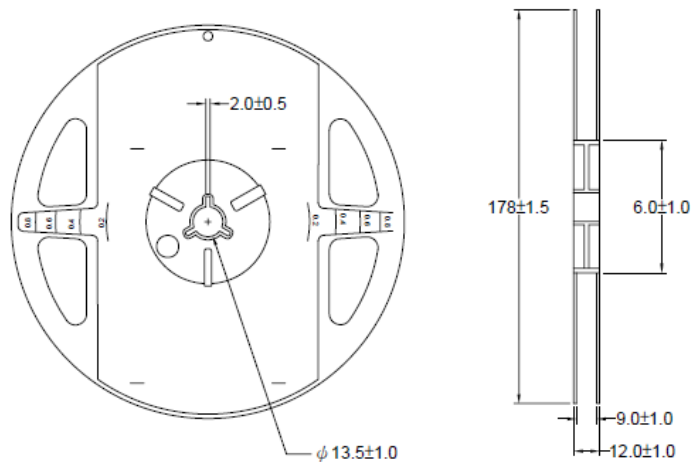

Note: 8.0mm Tape, 7" Reel. 3,000 devices per reel.



ChromeLED Corp. reserves the right to make changes at any time in order to supply the best product possible. The most current version of this document will always be available at: [www.chromeled.com](http://www.chromeled.com)